

Instructions for assisted collection of saliva

- Do NOT eat, drink, smoke or chew gum for 30 minutes before giving your saliva sample.
- Do NOT remove the plastic film from the funnel lid.
- Check sponge for damage each time before inserting into donor's mouth. Use second sponge if first sponge shows any signs of wear or tear.
- Do NOT substitute with other sponges or swabs.

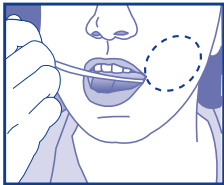

Place one sponge in cheek pouch. Gently move the sponge along the gums and inner cheeks for 30 seconds to soak up as much saliva as possible.

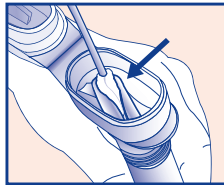

Once sponge is saturated, insert sponge in V-notch of funnel. Wring saliva out of sponge using a twisting and pushing motion against the inner wall of the V-notch. Saliva will flow into tube.

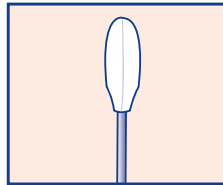

Check sponge for damage each time before inserting into donor's mouth. Use second sponge if first sponge shows any signs of wear or tear.

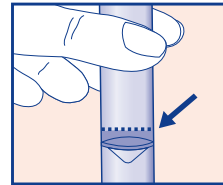

Repeat these steps (1 to 2) USING THE SAME SPONGE until the liquid saliva (not bubbles) reaches the fill line. Tap tube bottom against hard surface to reduce number of bubbles.

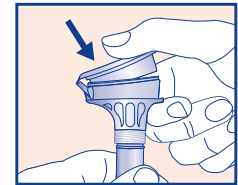

Hold the tube upright with one hand. Close the lid with the other hand (as shown) by firmly pushing the lid until you hear a loud click. The liquid in the lid will be released into the tube to mix with the saliva. Make sure the lid is closed tightly.

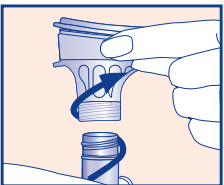

Hold the tube upright. Unscrew the funnel from the tube.

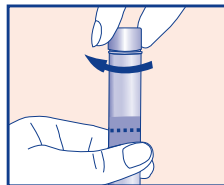

Use the small cap to close the tube tightly.

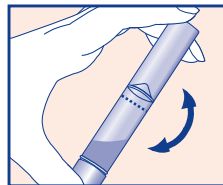

Shake the capped tube for 5 seconds. Discard the funnel and sponges.



Write the patient name and DOB on the label provided in your kit.

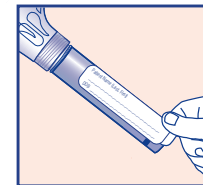

Apply this label to the sample tube – please do not cover the barcode.

Mailing instructions

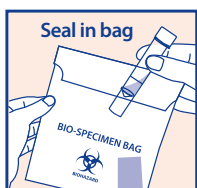

10. Seal the tube in bag provided and place in box.

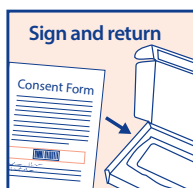

11. Fold signed consent form and place in box.



12. Close box and seal.



13. Mail from nearest USPS location (postage paid).

OR



14. Drop in nearest FedEx drop location if return label is FedEx

Need help?

Phone:
877.395.7608
617.714.0315

Email:
support@
courtagen.com

⚠ Small cap, choking hazard. Wash with water if stabilizing liquid comes in contact with eyes or skin. Do NOT ingest.

Donor's Name and Date of Birth (MM/DD/YEAR): _____