

SCHOOL WORKBENCH WBSCH MANUAL



LAGUNA

LAGUNA TOOLS
2072 Alton Parkway
Irvine, California 92606
Ph: 800.234.1976
www.lagunatools.com

LAGUNA

OPERATION MAUNAL 48" x 48" OAK WORKBENCH (WBSCH)

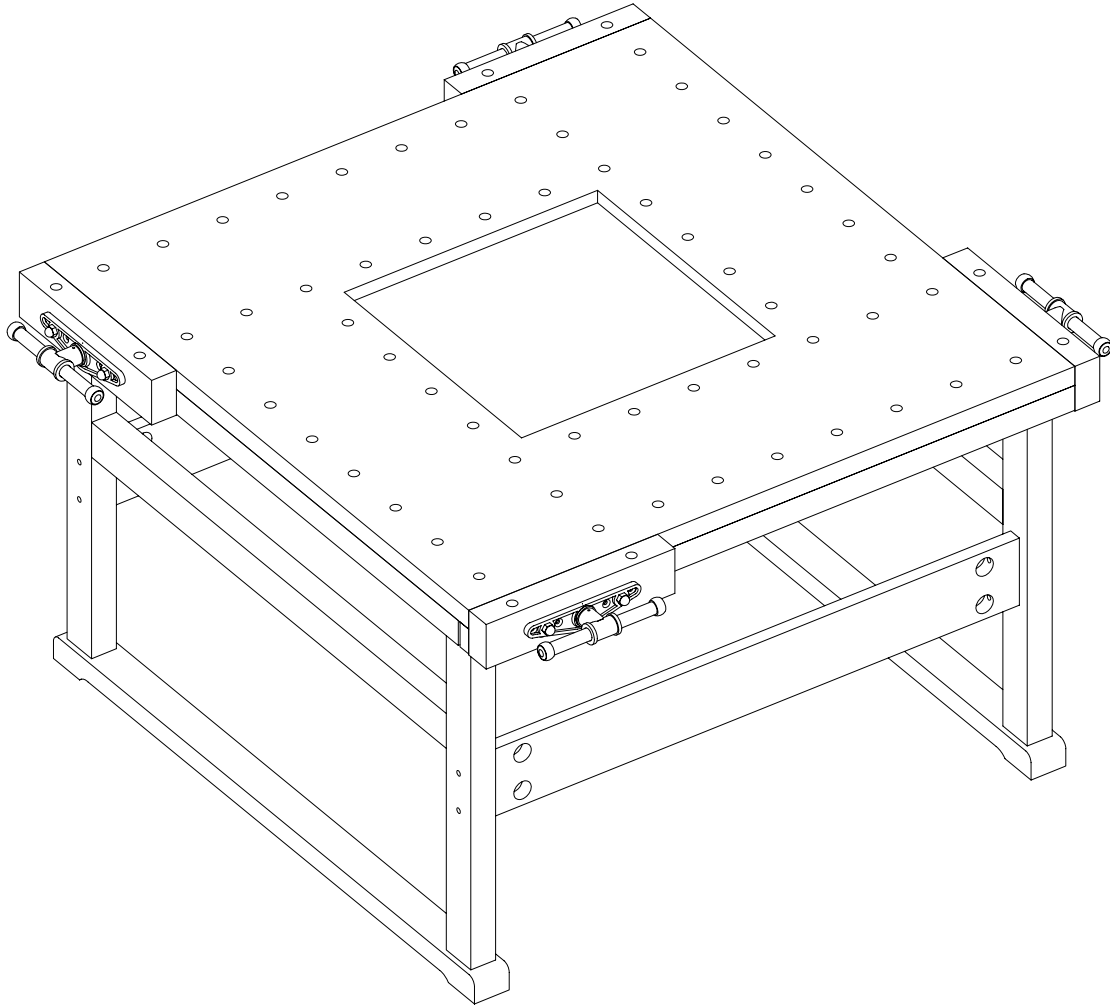

FEATURES

- Solid 1.5" thick table top with 2.5" thick skirt for extra support, total edge thickness is 4".
- Includes both front and end vises with a double row of bench dog holes in the table for each vise.
- Large storage ball bearing slides drawer.
- Includes ten bench dogs and four wooden stopper bar.
- All wooden components are lacquer painted.

SPECIFICATIONS

- TABLE DIMENSIONS: 48" x 48"
- VISE DIMENSIONS: 13" x 2" x 3.5"
- MAX. VISE TRAVEL: 4"
- WEIGHT: 98 KGS

ASSEMBLY INSTRUCTIONS:

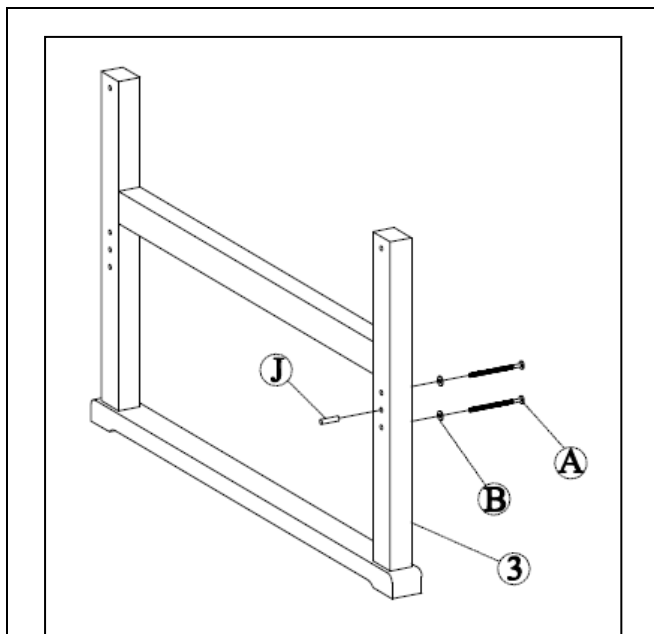

(FIG. 1)

Please insert the cap screw (No. A) with washer (No. B) into the right stand (No. 3). Insert the wood pin at the center hole.

See (FIG. 1)

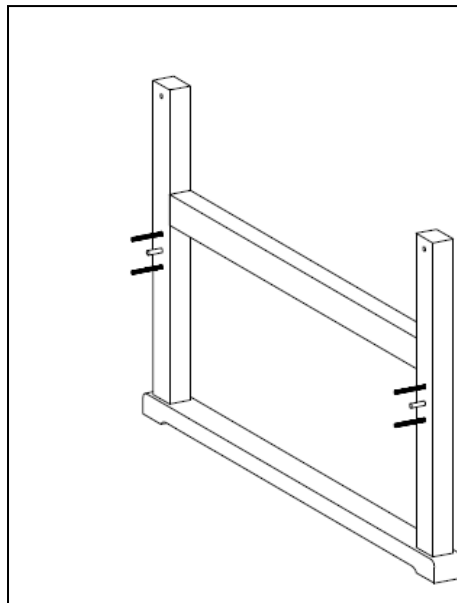

(FIG. 2)

Repeat the same steps on the other side of the left stand.

See (FIG. 2)

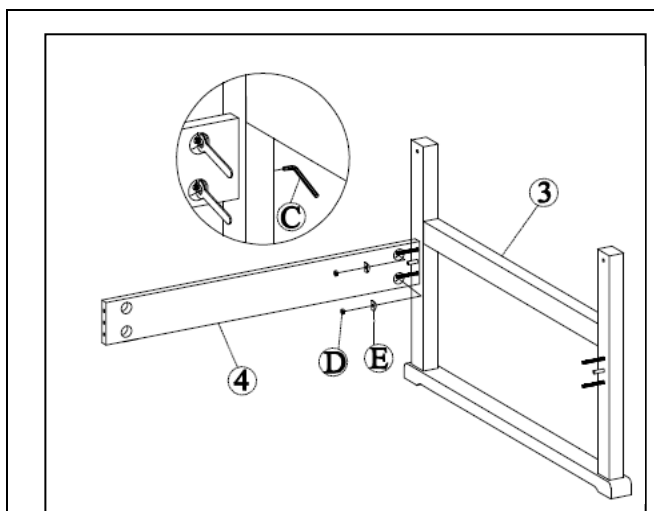

(FIG. 3)

Attach the side support (No. 4) to the right stand as shown and secure with a moon nut (No. E) and hex nut (No. D). Tighten with the supplied 5mm Allen Wrench (No. C) and a 14mm wrench as shown.

See (FIG. 3)

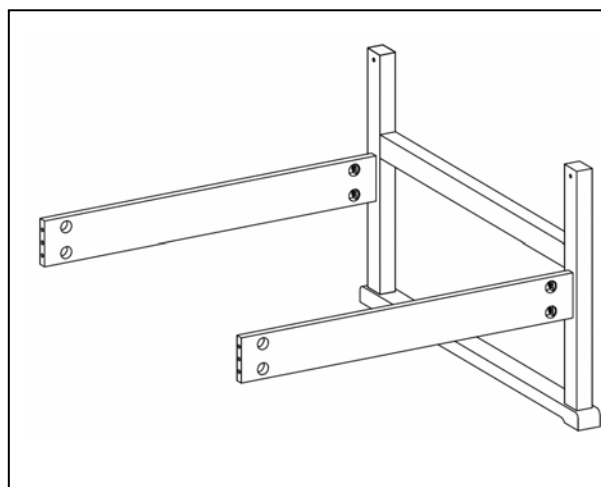

(FIG. 4)

Repeat Step 3 with the other side support.

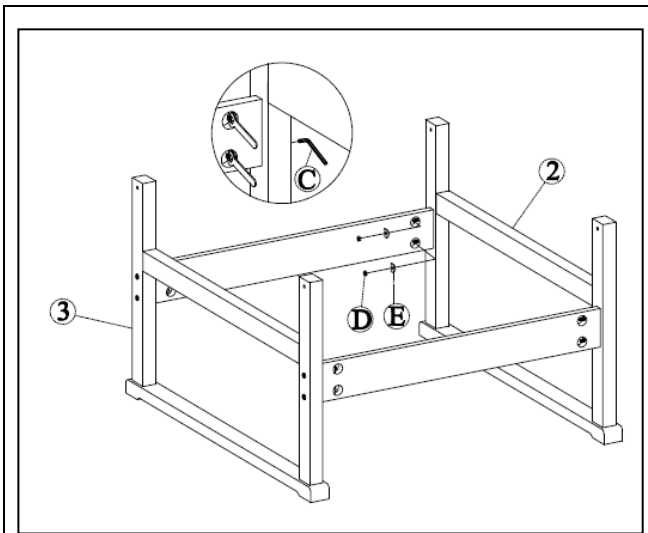

(FIG. 5)

Repeat step 1 with the left stand then attach the left stand to the front and side support as shown and secure with a moon nut (No. E) and hex nut (No. D). Tighten with the supplied 5mm Allen Wrench (No. C) and a 14mm wrench as shown.

See (FIG. 5)

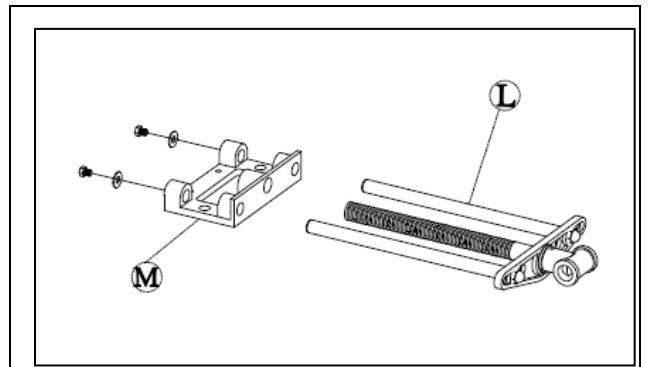

(FIG. 6)

Disassemble the vise support bracket with a 12 mm wrench.

See (FIG. 6)

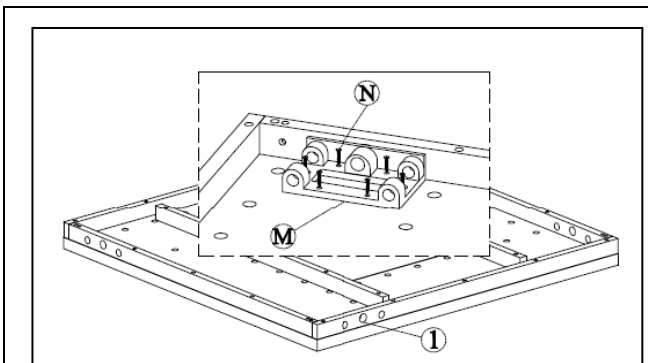

(FIG. 7)

From the underside of the table, align the holes on the vise support bracket (No. M) with the holes on the side edge of the table (No. 1) and secure using 6 wood screws (No. N) (supplied).

See (FIG. 7)

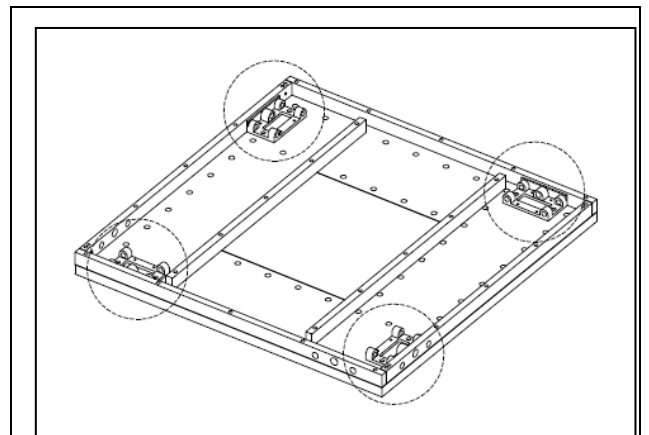

(FIG. 8)

Repeat the step 6 and step 7 to assembly the other 3 vise support brackets to the table top.

See (FIG. 8)

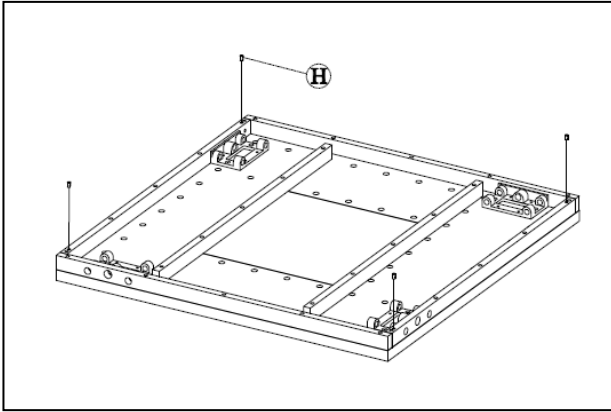

(FIG. 9)

Insert the nut (No. H) into the table edge.

See (FIG. 9)

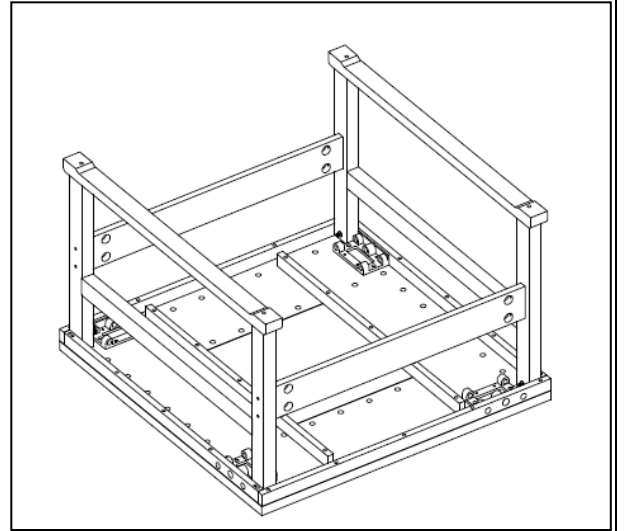

(FIG. 10)

Turn the stand assembly up side down and carefully lower it into the underside of the table as shown.

See (FIG. 10)

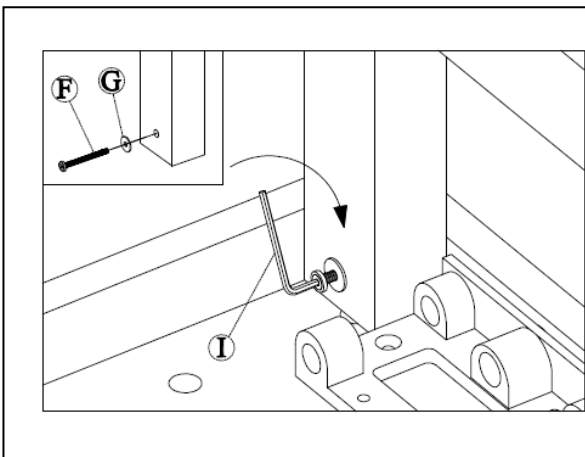

(FIG. 11)

Line up the pre-drilled holes in each end of the stand with the holes in the mounting blocks secured under the table. Secure the stand to the table at both ends with cap screws (No. F) and washer (No. G). Tighten with the supplier 4mm Allen Wrench.

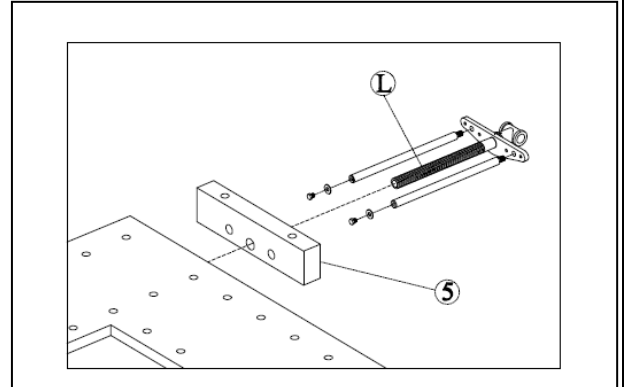

(FIG. 12)

Insert the screw assembly (No. L) through the middle hole of a vise block (No. 5) then thread the screw in the middle hole of the vise support bracket, on the right side of the workbench.

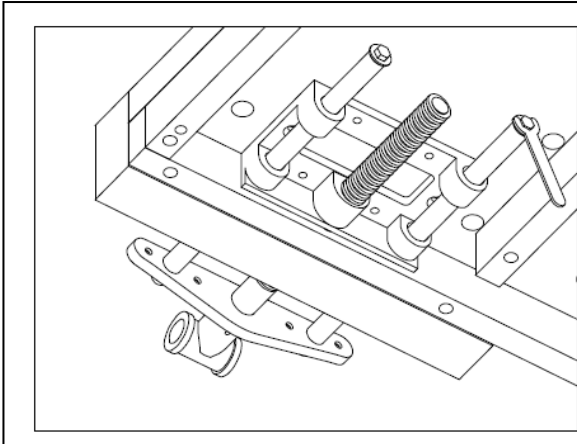

(FIG. 13)

From under the table, re-install the flat washers and bolts previously removed as step 6, and tighten with a 12mm wrench.

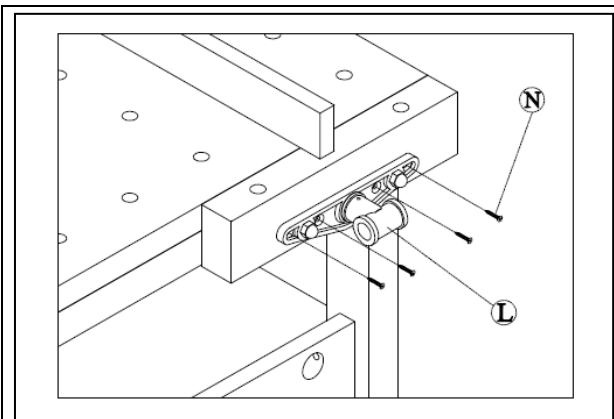

(FIG. 14)

Place a straightedge on the table and vise face. Manually adjust the vise face, so it is leveled with the table top then firmly tighten the screw (No. L) to secure the vise face in position. With the vise face leveled with the table top, secure the screw assembly to the vise face with 4 wood screws (No. N).

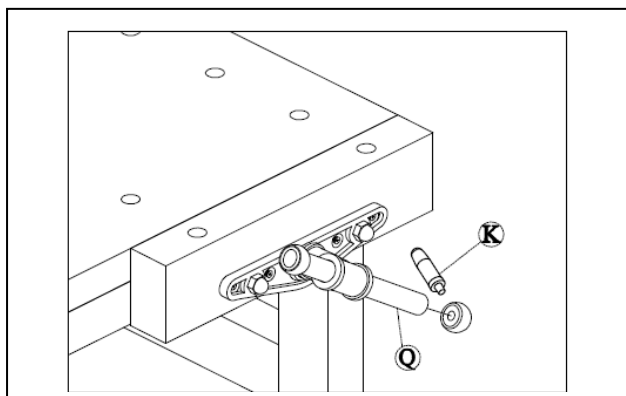

(FIG. 15)

Remove the end cap of handle (No. Q) from both ends of one vise handle (No. Q) then insert the handle through handle holder as shown and glue the caps back on the handle using the supplied glue tube.

Repeat steps 12 to step 15 with the second screw assembly on the front edge of the workbench.

EXPLODED DIAGRAM:

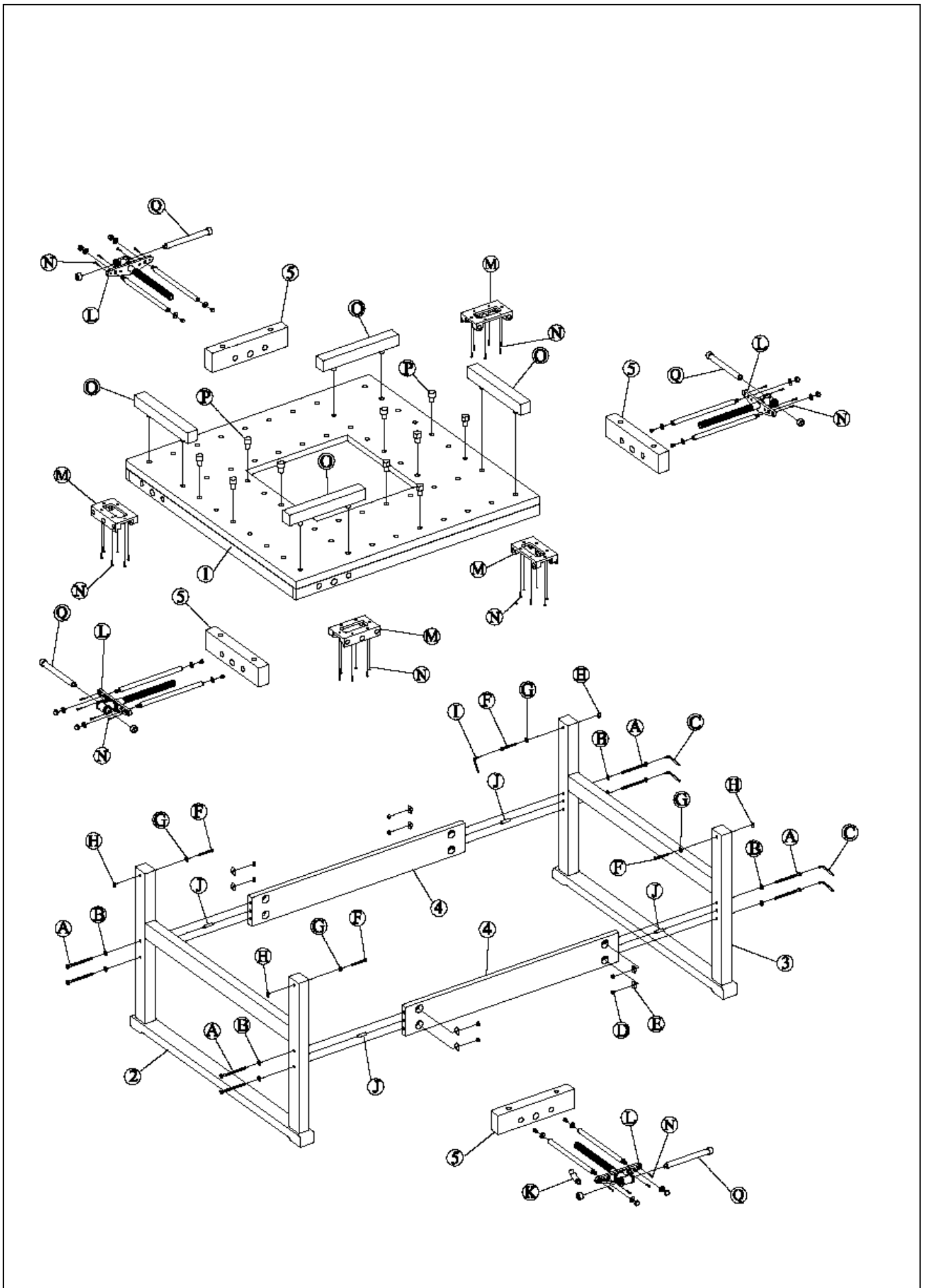

PART LIST:

<u>NO.</u>	<u>DESCRIPTION</u>	<u>SPECIFICATION</u>	<u>Q'TY</u>
A	Cap Screw	M8 x 120mm	8
B	Washer	Ø8-Ø19mm	8
C	Allen Wrench	5mm	1
D	Hex Nut	M8 x 14 x 6mm	8
E	Moon Nut	30 x 15 x 8mm	8
F	Cap Screw	M6 x 70mm	4
G	Washer	Ø6-Ø19mm	4
H	Nut	Ø9 x 13mm	4
I	Allen Wrench	4mm	1
J	Wood Pin	Ø10 x 40mm	4
K	Glue		1
L	Vise		4
M	Vise Support Bracket	180 x 110 x 43mm	4
N	Flat Head Wood Screw	M4 x 25mm	40
O	Stopper Bar	380 x 75 x 50mm	4
P	Stopper	28.5 x 45mm	10
Q	Handle	Ø15.5 x 264mm	4
1	Table Top	1220 x 1220 x 38mm	1
2	Left Support Leg	1210 x 762 x 70mm	1
3	Right Support Leg	1210 x 762 x 70mm	1
4	Side Support	1070 x 135 x 25mm	2
5	Vise Block	380 x 90 x 50mm	4

LAGUNA

2072 Alton Parkway. Irvine, CA 92606
Ph: 800.234.1976 | www.lagunatools.com

Laguna Tools is not responsible for errors or omissions.
Specifications subject to change. Machines may be shown with optional accessories.

© 2018, Laguna Tools, Inc. LAGUNA® and the LAGUNA Logo® are the
registered trademarks of Laguna Tools, Inc. All rights reserved.