

H-D® WOOD BAR STOOL ASSEMBLY INSTRUCTIONS

VO4

Congratulations on your purchase of aH-D® Nostalgic Bar & Shield Wood Bar Stool. The utmost care has gone into the design and manufacturing of this product.

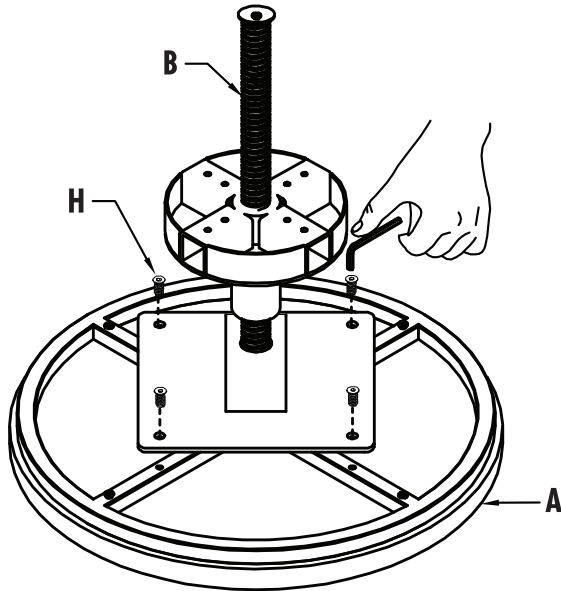

Step 1

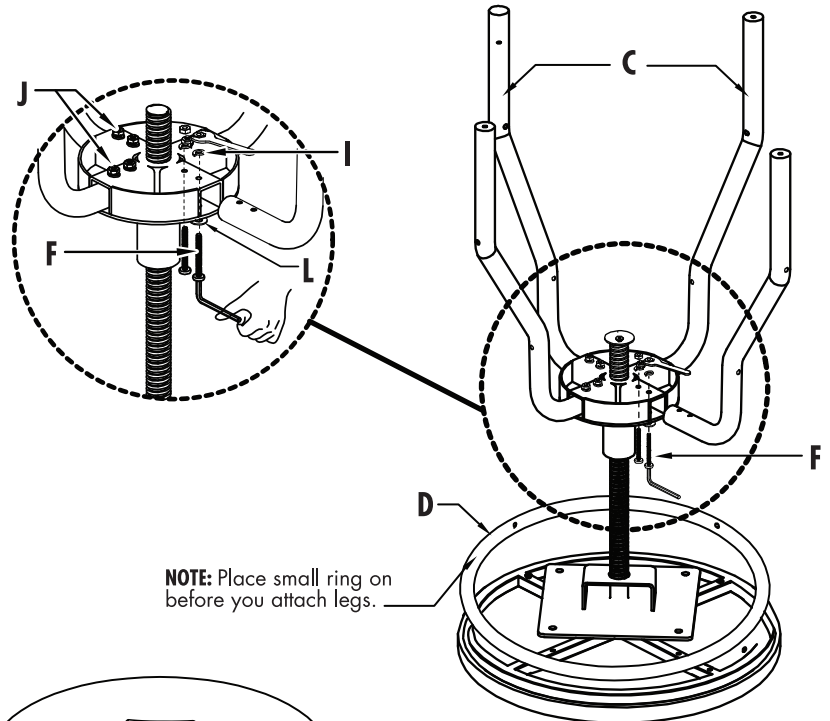

NOTE: Place small ring on before you attach legs.

Step 2

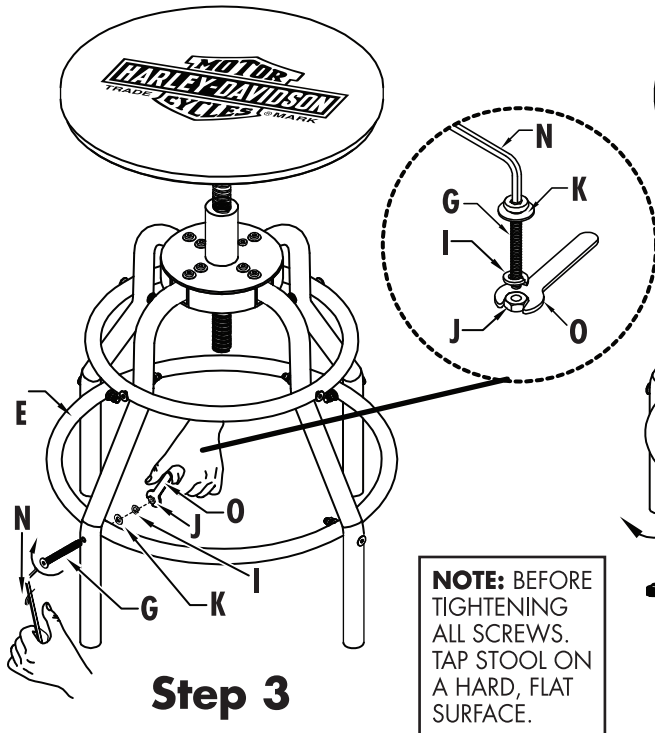

Step 3

NOTE: BEFORE TIGHTENING ALL SCREWS. TAP STOOL ON A HARD, FLAT SURFACE.

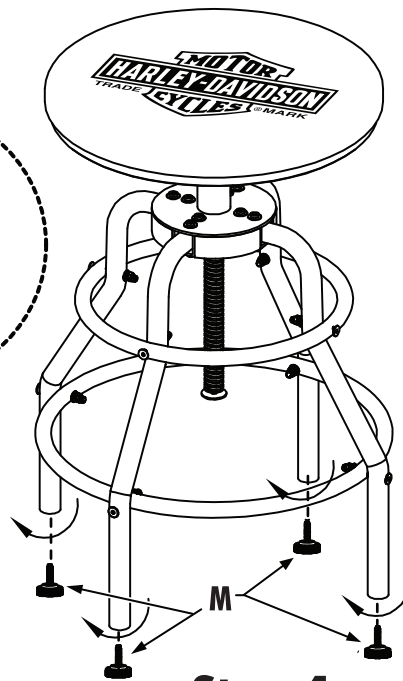

Step 4

NOTE: USE EXTRA WASHERS BETWEEN WOOD SEAT AND CENTER ASSEMBLY TO LEVEL SEAT.

PART DESCRIPTION	QTY
A Wood Seat Top	1
B Center Assembly	1
C Legs	4
D Small Ring	1
E Large Ring	1
HARDWARE LIST	
	QTY
F Large Bolts	8
G Medium Bolts	8
H Small Bolts	4
I Split Washer	20
J Nut	16
K Small Washer	8
L Large Washer	12
M Feet	4
N Allen Wrench	1
O Wrench	1

WARRANTY:

Free replacement of any part that fails within 90 days from date of purchase, excluding shipping costs. Void if damaged by misuse, accidents, alterations, failure to follow instructions, fire, flood, and acts of God.

If you have any questions or comments, please contact us at: **BrandedProducts.com**

LEVELING INSTRUCTIONS FOR H-D® WOOD BAR STOOL

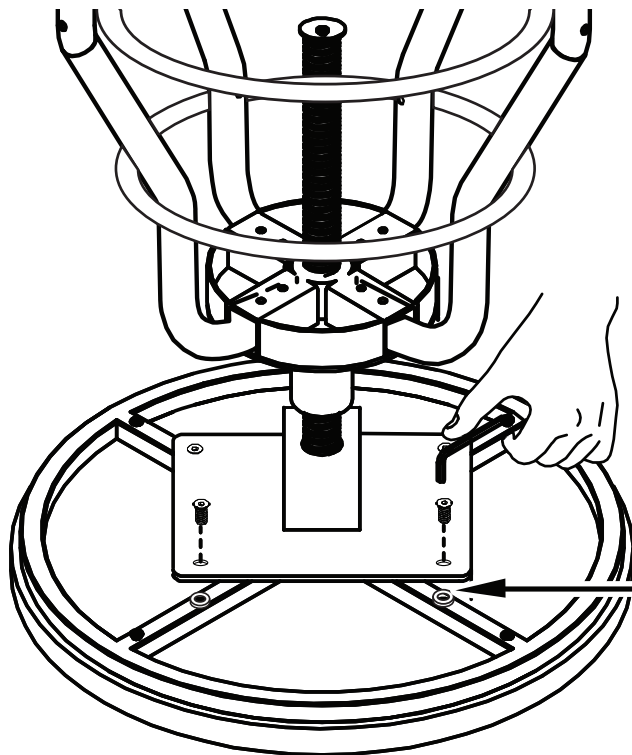

NOTE: IF SEAT IS NOT LEVEL USE AS MANY WASHERS AS NECESSARY BETWEEN WOOD SEAT AND CENTER ASSEMBLY TO LEVEL SEAT TOP.

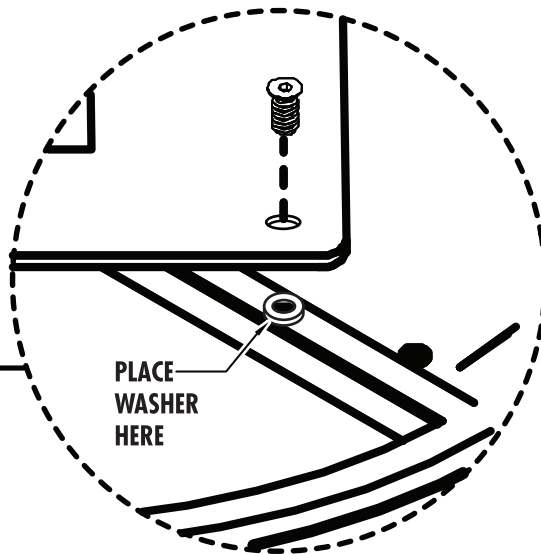

Harley, Harley-Davidson and the Bar & Shield Logo are among the trademarks of H-D Michigan, LLC.
©2012, All Rights Reserved. Manufactured by APMGI under license from Harley-Davidson Motor Co.

Ace Product Management Group, Inc.
Milwaukee, WI U.S.A.