

Installation Instructions

Kit #26723101 – NGX STAND With SubWoofer

Note: If using an NGX Ultra with this stand, NGX Ultra Mounting Kit 26694601 is required.

Tools needed:

Philips screw driver, 1/4", 5/16", 3/8" & 7/16" nut drivers

Parts included in this kit:

Item	Part #	Description	Quan
1	61210801	Stand-Jukebox with Subwoofer	1
2	21121216	Power Cord	1
3	30934226	Cable - Audio 72"	1
4	70134154	U-Bolt	1
5	70120926	Washer-Flat 1/4"	2
6	87835700	#1/4-20 Hex Nut	2
7	80715716	#1/4-20 x 1 SEMS Hex Screw	5
8	22340401	Leveling Mount-Leg	4



1. The NGX Stand with Subwoofer provides for an attractive, stable and portable platform for mounting any of the AMI Entertainment Network NGX jukebox models. The stand incorporates a powered subwoofer to enhance that deep bass sound that locations require.
2. Sound from the subwoofer is directed out the front of the stand through the speaker grill and also out a speaker port in the bottom of the stand. It is important to keep an open space between the bottom of the stand and the floor.
3. Leg levelers (item 8) are provided to lift the stand off the floor and allow for adjustment for uneven flooring. Start with all four leg levelers screwed all the way into the stand base then lengthen the levelers in the corners where the leveler does not hit the floor. Be sure the stand is level and stable before proceeding to mount an NGX jukebox.
4. The stand is equipped with T-nuts installed in various positions to accommodate different NGX model jukeboxes. Referring the figure to the right, mount the jukebox using 1/4"-20 x 1" SEMS hex screws (item 7) into the designated T-nuts.

NGX	N
NGX Mini	M
NGX Mini 2	M
NGX Ultra	U (B*)

(*T-nuts designated with B are used with the NGX Ultra mounting kit adaptor brackets.)

For the full size NGX jukebox you will not use the upper most holes in the jukebox cabinet. The NGX jukebox will mount such that the top of the jukebox is higher than the top of the stand.

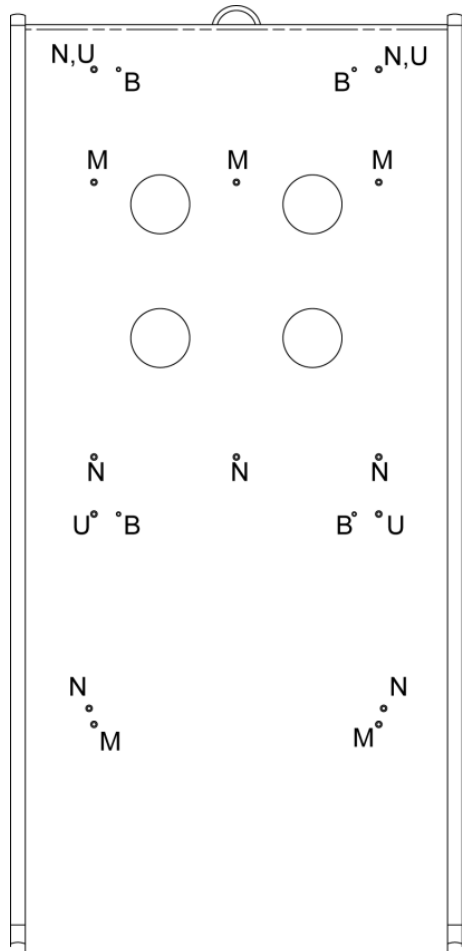

5. Once the jukebox is mounted to the stand route the power cord supplied with the jukebox from the jukebox power distribution unit into the back of the stand through one of the access holes. Plug the power cord into the junction box in the stand. Be sure the power cord from the subwoofer is also plugged into the junction box.
6. Use the Audio Cable (item 3) to connect the preamplifier CH1 and CH2 outputs to the Line In RCA jack inputs on the back of the subwoofer.
7. Use the power cord (item 2) to connect the subwoofer stand to a standard 120 volt wall outlet.

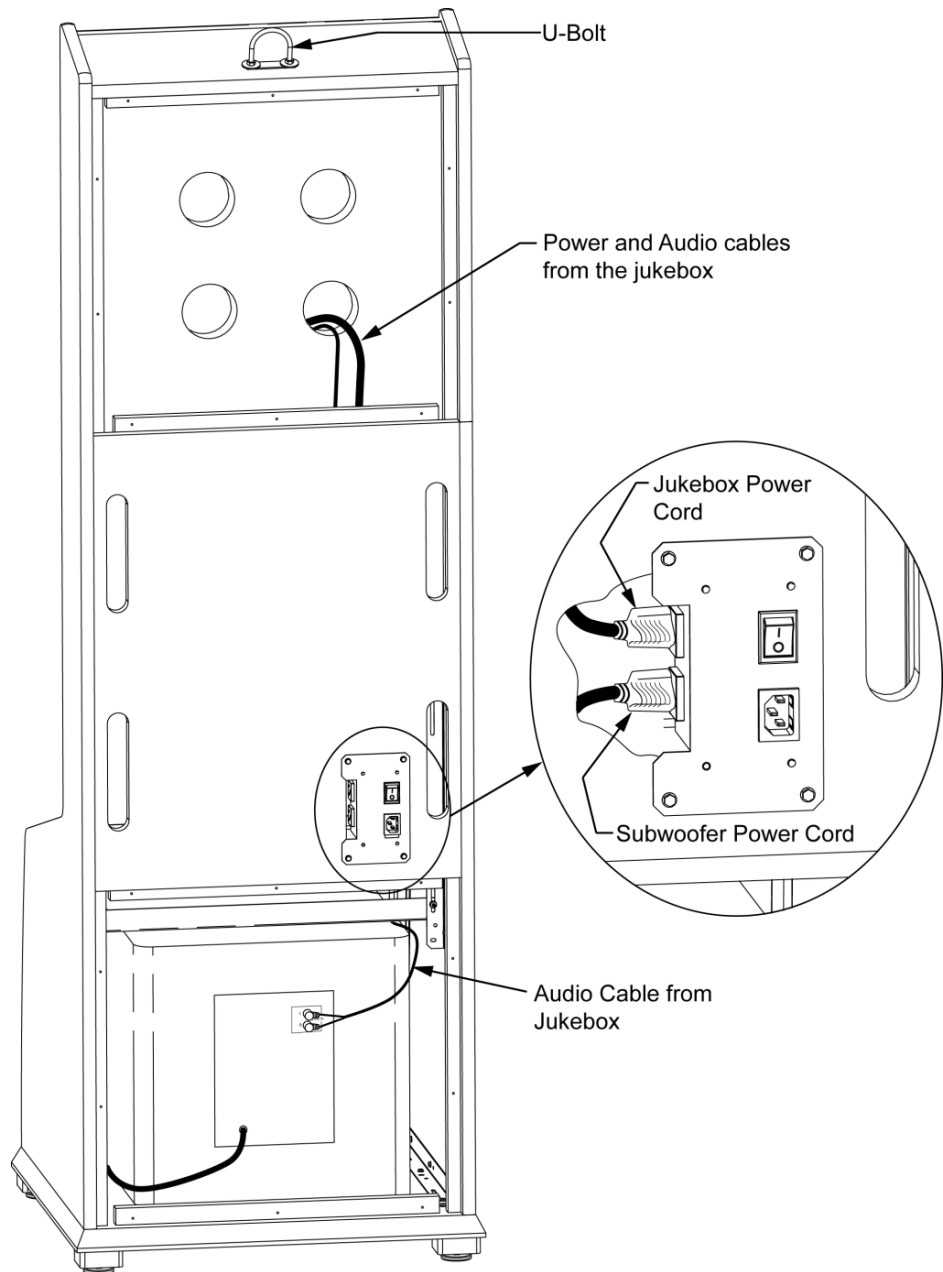

8. A U-bolt and associated fasteners (items 4, 5, and 6) has been provided and should be installed on the top of the subwoofer stand in the holes provided. A safety strap or cable can be connected to this U-bolt then connected to a wall or other sturdy point to prevent the stand from being tipped over.



Operation

On the back panel of the powered subwoofer, a Power switch along with Gain and Crossover controls are provided. Be sure the Power switch is in the ON position and the Power LED is lit green. Adjust the Gain and Crossover controls to the middle positions.

Select and play a representative song on the jukebox. Adjust the volume in the location to a representative level most used by the location. Adjust the subwoofer Gain and Crossover controls to balance the low frequency sound from the subwoofer with the speakers in the location.

Setting the gain too high will cause the low frequencies to sound too boomy. In this case more gain is not always a good thing. Setting the Crossover too high will interfere with the low frequency response of the other speakers and muddy up the sound. A setting around 80Hz will most likely be optimum.

The subwoofer also has a Phase switch which allows for either 0° or 180° phase shift of the bass coming from the subwoofer. Test the subwoofer using both positions. Leave the Phase switch in the position which provides the best bass sound.

Refer to the SUB-1200 Operators Manual for additional information about using the subwoofer.



Item	Part #	Description	Quan
1	70134154	U-Bolt	1
2	70120926	#1/4 Flat Washer	2
3	87835700	#1/4-20 Hex Nut	2
4	61210901	Cabinet-Bass Speaker Stand	1
5	61211101	Panel-Back Cover	2
6	22340601	Cover-Back Panel	2
7	86323620	#8 x 1-1/4 PFH (type 17) black	28
8	41024701	Bracket-Brace, Mounting	8
9	34106702	Junction Box Assy	1
10	86663610	#8 x 5/8 Hex Head Screw (type 17)	4
11	22340401	Leveler-Leg	4
12	22340501	SubWoofer-SUB1200	1
13	34116301	Bracket-Speaker Retainer	1
14	61211001	Panel-Speaker	1
15	80713010	#8-32 x 5/8 SEMS Hex Screw	6
16	41024901	Grill-Speaker	1
17	41025201	Trim-Speaker Panel (Bottom)	1
18	41025101	Trim-Speaker Panel (Side)	2
19	41025001	Trim-Speaker Panel (Top)	1
20	87843000	#8-32 KEPS Hex Nut	16

