

# USER INSTRUCTIONS

## GRILLOGAS

MODEL No 740T-I3



**LIVE THE BRAAI LIFE**





**LIVE THE BRAAI LIFE**

**CADAC INTERNATIONAL**

P.O. Box 43196,  
Industria, 2042 South Africa  
Tel: +27 11 470 6600  
Fax: +27 11 472 9401  
Email: info@cadac.co.za  
www.cadac.co.za

**CADAC CANADA**

Hus-tek, 7 Circle Court,  
Thornhill Ont, L3T 7M3  
Tel: (905) 731-2660  
Mobile: (647)298-6789  
Email: soren@hus-tek.com

**CADAC EUROPE**

Ratio 26, 6921 RW Duiven  
The Netherlands  
Tel: +31 26 319 7740  
Fax: +31 26 319 7743  
Email: info@cadaceurope.nl  
www.cadaceurope.com

**CADAC GERMANY**

Ratio 26, 6921 RW Duiven  
The Netherlands  
Tel: +31 26 319 7740  
Fax: +31 26 317 7743  
Email: info@cadaceurope.nl  
www.cadaceurope.com

**CADAC ZIMBABWE**

Exclusive Brands Africa  
Unit 8 Birkenhead Park  
43 Josiah Chinamano Street  
Belmont, Bulawayo  
Tel/Fax: +263 971 740  
(Bulawayo)  
Tel/Fax: +263 479 2564  
(Harare)  
www.CADAC.co.zw

**CADAC CHINA**

Room 811, Huayue Inter-  
national Building, No.255  
Tiangao Road, South Yinzhou  
business district,  
Ningbo, China  
Zip:315199  
FAX:+86 574 87364160  
TEL:+86 574 87723937  
info@cadac.com.cn

**CADAC AUSTRALIA**

CADAC-BBQ Pty Ltd, Australia  
Tel: +61 420 503 967  
Customer Care: 1300 135 011  
Fax: +61 755 728 682  
Email: info@cadacbbq.com.au  
www.CADACbbq.com.au

**CADAC FRANCE**

Le Viallon, 42520 Veranne  
France  
Tel: +33 4 74 78 13 65  
Email : info@cadaceurope.nl  
Web : www.cadaceurope.com

**CADAC SCANDINAVIA**

CIBA A/S  
Industrivej 11  
DK - 6640 Lunderskov  
Tel: +45 76 31 44 45  
Mobile: +45 29 47 44 40  
Fax: +45 7558 6899  
Email: LN@cibas.dk

**CADAC NEW ZEALAND**

Riverlea Group (Pty) Ltd  
PO Box 11062, 11 Kells Place,  
Hamilton 3251, New Zealand  
Tel: +64 7 847 0204  
Fax: +64 7 847 0205  
Email: sales@riverleagroup.co.nz  
http://www.riverleagroup.co.nz

**CADAC CZECH**

RÖSLER Praha spol. s r.o.  
Výhradní zastoupení  
pro ČR a SR  
Elšísky Junkové 1394/8, 102 00  
Praha 10, Česká republika  
Tel.: +420 267 188 011  
Fax.: +420 272 651 046  
E-mail: obchod@rosler.cz  
www.rosler.cz

**CADAC SWITZERLAND**

Dipius SA  
Rte du Bleuët 7  
CH-1762 Givisiez  
Tel. +41 26 470 47 47  
Fax. +41 26 470 47 40  
Email: info@dipius.ch

**CADAC MOZAMBIQUE**

Exclusive Brands Africa  
492 Avenida Namaacha  
Maputo, Mozambique  
Tel: +258 21 406254  
www.CADAC.co.mz

**CADAC ITALY**

Brunner SRL/GMBH  
Via B.Buozzi 8 /  
B.Buozzi Strasse 8  
I - 39100 Bolzano / Bozen  
Tel: 0471/542931  
Fax: 0471/542905  
www.brunnerinternational.com

**CADAC UK**

1 Open Barn  
Backridge Farm Business Centre  
Twitter Lane, Bashall Eaves  
Clitheroe, BB7 3LQ, UK  
Tel: +44 333 200 0363  
Fax: +44 333 200 0364  
Email: info@cadacuk.com  
www.cadac.uk.com

**CADAC HONG KONG**

Everything Under The Sun  
902 Horizon Plaza, 2 Lee Wing  
Street,  
Ap Lei Chau, HK  
Tel :+852 2554 9088  
Fax: +852 2818 8595  
Email:  
craig@everythingunderthesun.  
com.hk

**CADAC SPAIN**

Ratio 26, 6921 RW Duiven  
The Netherlands  
Tel: +31 26 319 7740  
Fax: +31 26 319 7743  
Email: info@cadaceurope.nl  
www.cadaceurope.com

**CADAC SOUTH EAST EUROPE**

Budimska 3  
11 000 Belgrade Serbia  
Tel: +381 11 339 2700  
Email: office@cadac.rs  
www.CADAC.rs

**CADAC KOREA**

Suite 502 Pika Bldg.  
Hogye-Dong, Anyang-Si,  
Gyeonggi-Do, South Korea  
Fax: +82 2 2179 9292  
Tel: +82 31 427 5466  
CADACKorea@gmail.com

**CADAC ZAMBIA**

Exclusive Brands Africa Limited  
7225A Kachidza Road  
Light Industrial Area  
Lusaka, Zambia  
Tel: +260 (0)969 515908  
Email: info@ebagrp.com

**CADAC UNITED ARAB EMIRATES**

Picnico General Trading  
PO Box 1797  
Dubai  
UAE  
Tel. nr: +971 4 267 9992  
Fax: +971 4 267 9940  
Email: showroom@picnico.ae



**CAUTION**

*For Outdoor use only! This appliance may not be used in an exterior enclosed balcony, porch or entertainment area.*

**IMPORTANT**

*Read these instructions carefully so as to familiarise yourself with the appliance before use.  
Retain these instructions for future reference.*

**GB****1. General**

- This Appliance complies with BS EN 498:2012 and BS EN 484:1998
- This appliance shall only be used with an approved hose and regulator.
- The gas cartridge/refillable cylinder is to be used only in the upright position.
- Note: To ensure satisfactory operation when using a cartridge always start up with a full cartridge and only when the intended period of continuous operation is less than approximately 45 minutes.
- Gas appliances require ventilation for efficient performance and to ensure the safety of users and other persons in close proximity as the appliance consumes oxygen.
- Use Outdoors Only

**2. Technical and model specifications****Table 1**

<b>740-10, 740-20, 740-30</b>				
<b>Country of use</b>	DK, FI, NO, NL, SE, AT, DE	BE, ES, FR, IE, IT, PT, GB, CH	PL	AT, DE
<b>Appliance Categories</b>	I <sub>3B/P</sub> (30)	I <sub>3+</sub> (28-30/37)	I <sub>3B/P</sub> (37)	I <sub>3B/P</sub> (50)
<b>Allowable gases and operating pressure</b>	Butane @ 28-30mBar Propane @ 28-30mBar Butane/Propane mixtures @ 28-30mBar	Butane @ 28-30mBar Propane @ 37mBar	Butane @ 37mBar Propane @ 37mBar Butane/Propane mixtures @ 37mBar	Butane @ 50mBar Propane @ 50mBar
<b>Nominal usage</b>	182 grams/hour	182 grams/hour	182 grams/hour	182 grams/hour
<b>Gross nom. heat input</b>	2,5 kW	2,5 kW	2.5 kW	2.5 kW
<b>Jet Number</b>	81		74	69
<b>Gas supply sources:</b>	An approved hose and regulator connected to:			
<b>a)</b>	A refillable gas container not exceeding 11kg and complying with local regulation in force			
<b>b)</b>	CA 445 / CA500 Cadac or equivalent EN 417 compliant disposable cartridge			

<b>Country name abbreviations</b>			
AT = Austria	DK = Denmark	GB = United Kingdom	NO = Norway
BE = Belgium	ES = Spain	IE = Ireland	PL = Poland
CH = Switzerland	FI = Finland	IT = Italy	PT = Portugal
DE = Germany	FR = France	NL = Netherlands	SE = Sweden

### 3. Safety Information

#### Hose

- The hose must be checked for wear or damage before every use and before connecting to the gas container.
- Do not use the appliance if it has a damaged or worn hose. Replace the hose.
- Do not use an appliance that is leaking, damaged or which does not operate properly.

#### Gas Container

- Ensure that the gas container is fitted or changed in a well-ventilated location, preferably outdoors, away from any sources of ignition such as naked flames, pilots, electric fires and away from other people.
- Keep gas containers away from heat and flame. Do not place on a stove or any other hot surface.
- Gas cartridges/refillable cylinders are to be used only in the upright position so as to ensure proper fuel withdrawal. Failure to adhere to this may cause liquid discharge from the gas container resulting in a dangerous operating condition.
- Do not try to remove the cylinder whilst the unit is in operation.
- The gas cylinder must be disconnected from the appliance after use or when in storage.
- Not for use with a remote gas supply.

#### Assembly and use

- Use only on a firm level surface.
- Do not move the appliance whilst the unit is in operation.
- Do not cover up or change the Base plate (Q) air holes on the Base Plate, as it will influence the flow of air to the Stem Air Holes (I) located inside the Tripod Housing (J). This, in turn, will affect the performance of the product and may lead to an unstable flame
- Ensure the appliance is used away from flammable materials. Minimum safe distances are:  
Above the appliance 1.2m. At the rear and sides 600mm. (See Fig.1)
- **Caution:** Accessible parts may become very hot, the use of protective gloves is recommended.
- Keep young children away from the appliance.
- Use Outdoors Only

#### Light back

- In the event of light back (where the flame burns back and ignites inside the burner or venturi housing), immediately turn off the gas supply by firstly closing the control valve on the gas container and then the appliance valve (M). After the flame is extinguished, remove the regulator and check the condition of the seal; replace the seal if in doubt. Re-light the appliance as described in Section 9 below. Should the flame persistently light back, return the product to your authorised CADAC repair agent.

#### Leaks

- If there is a leak on your appliance (smell of gas), take it outside immediately into a well-ventilated flame-free location where the leak may be detected and stopped. If you wish to check for leaks on your appliance, do it outside. Do not try to detect leaks using a flame; use soapy water.
- The correct way is to smear the joints with soapy water. If a bubble or bubbles form then there is a gas leak. Immediately turn off the gas supply firstly by closing the control valve on the gas container and then the appliance valve. Check that all the connections are properly fitted. Re-check with soapy water.
- If a gas leak persists, return the product to your CADAC dealer for inspection / repair.

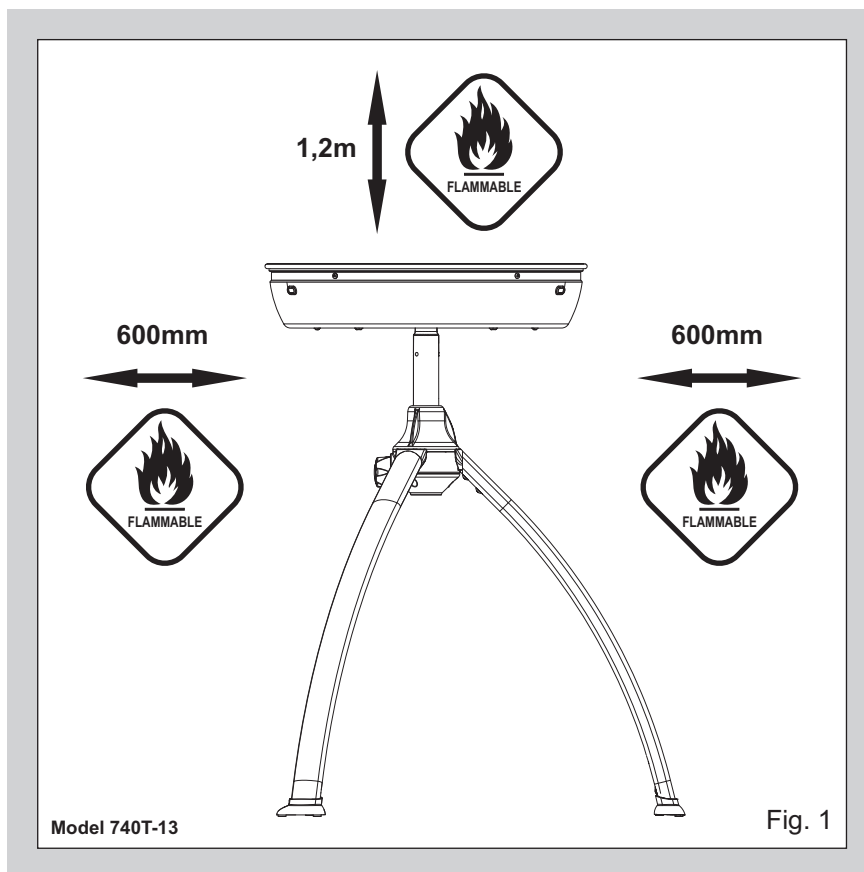

## 4.1 Exploded View

PRODUCT CODE: 740-10

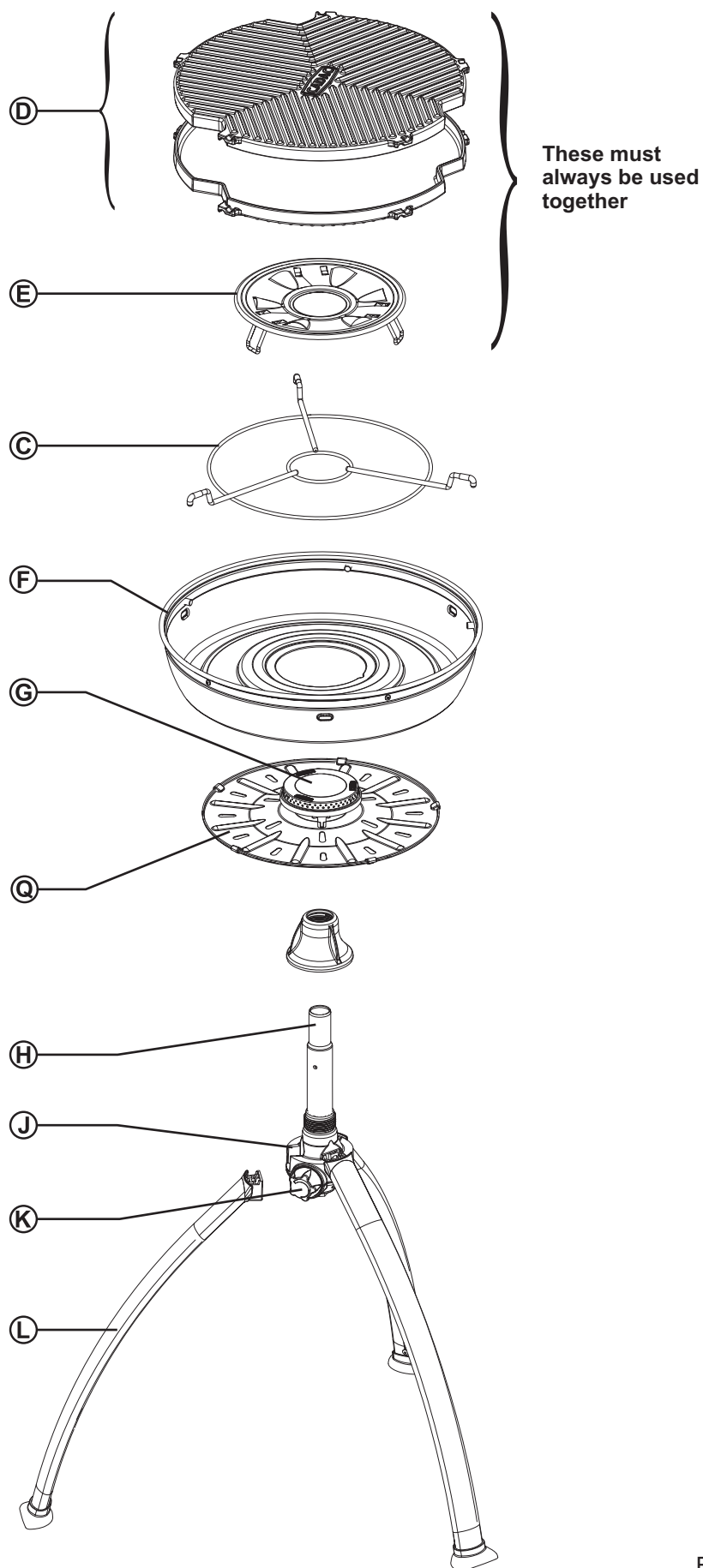
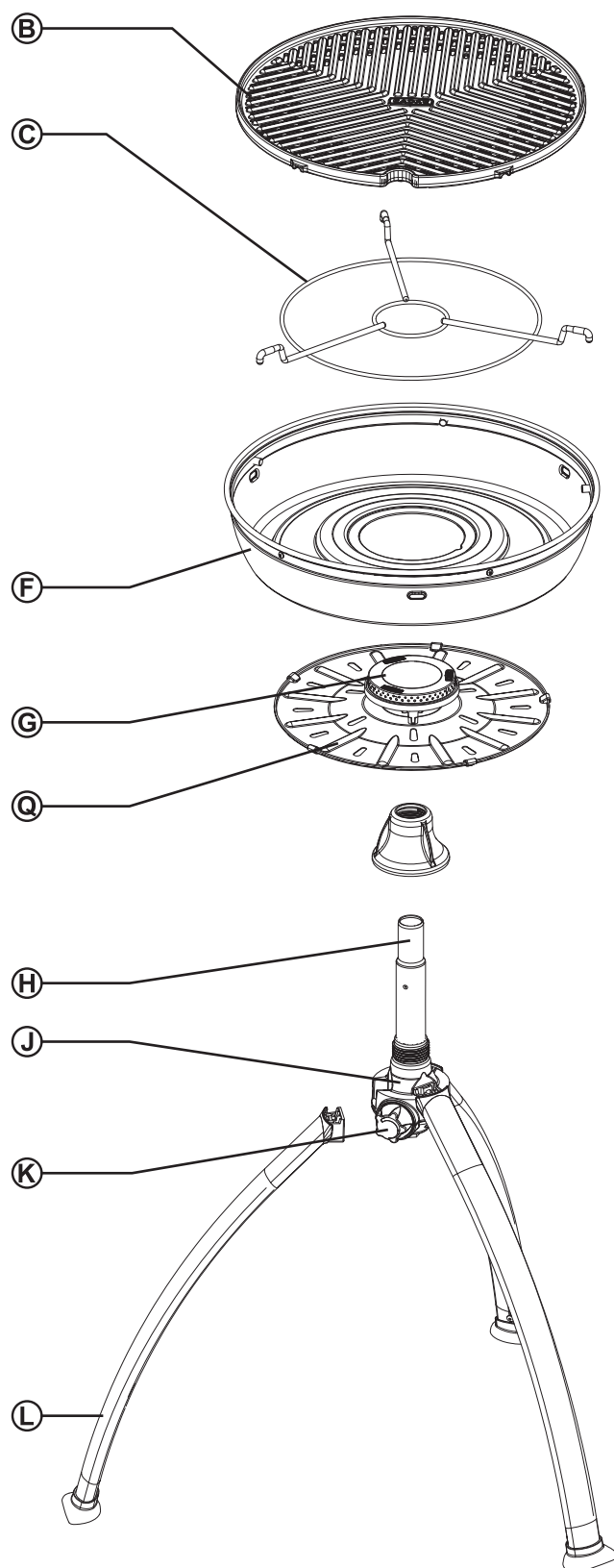

Fig. 2a

## 4.2 Exploded View

PRODUCT CODE: 740-20



### **PARTS LIST**

- B. BBQ Grid
- C. Pot Stand
- F. Burner Pan
- G. Burner
- H. Stem
- J. Tripod Housing
- K. Control Knob
- L. Leg
- M. Valve
- N. Lock Nut
- O. Jet
- P. Valve Tailpiece
- Q. Burner Base Plate

Fig. 2b





## 5. Assembly Instructions

- Note:** The hose and regulator are not supplied. For details contact your local stockist.

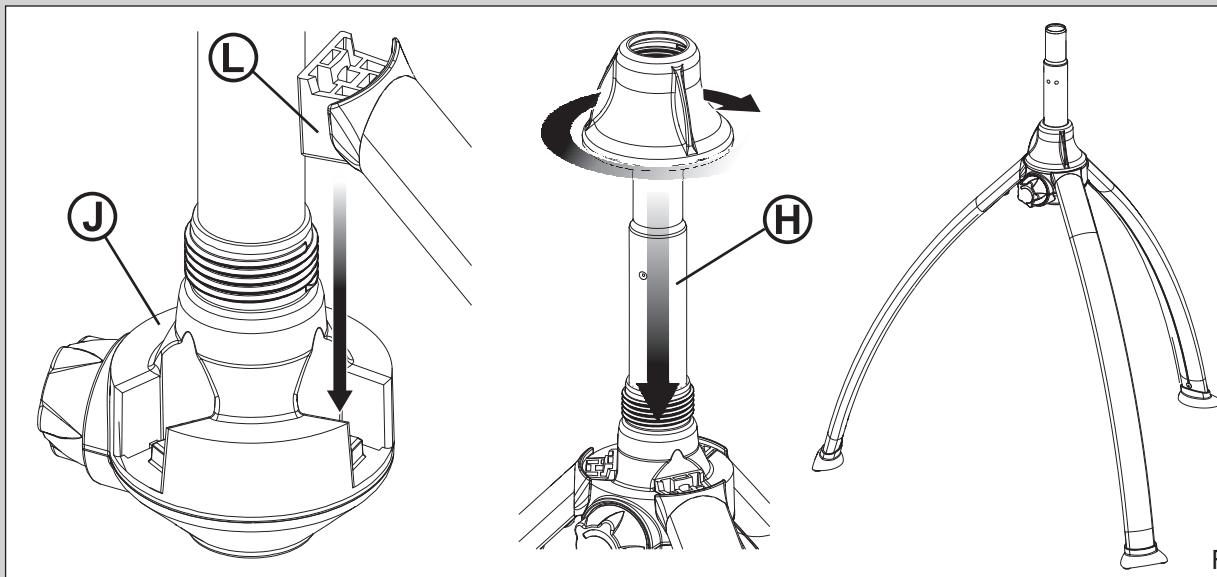

Fig. 3

- I 3B/P (30), I 3+ (28-30/37) and I 3B/P (37).

### Appliance categories:

(DK, FI, NO, NL, SE, AT, DE, BE, ES, FR, IE, IT, PT, GB, CH)

Fit the Valve Tailpiece (P) onto the Valve (M) (Fig.4) by screwing it on in an anti-clockwise direction. Push an 8mm inside diameter Hose onto the Valve Tailpiece (P) until it is properly seated (See Fig.4). On the other end, attach a suitable low-pressure regulator I(3B/P(30)): 30mbar butane/propane configurations regulator; I3+ (28-30/37): 30mbar butane regulator or 37mBar propane regulator; I3B/P(37):37mbar butane/propane configurations regulators), Again making sure that the hose is well seated.

The hose used must comply with BS 3212:1991 / SABS 1156-2 or equivalent. In South Africa the regulator used must comply with SANS 1237.

- I 3B/P (50) **Appliance category:** (AT, DE)

Screw a Hose with the correct threaded fittings on each end, onto the left hand 1/4" BSP thread of the Valve (O) (Fig.4). Attach a suitable 50mbar low-pressure regulator on the other end of the hose. The hose used must comply with DIN 4815 part 2 or equivalent.

- The hose length should be no less than 800mm and shall not exceed 1.5m. Check the expiry date on the hose and replace when necessary or when national conditions require it.
- Do not twist or pinch hose. Do not route the hose in any manner that will cause it to come into contact with any surfaces that would become hot during use.
- Before fitting your gas cylinder (Section 7), ensure that the Valve (M) is in the OFF position by turning the Control Knob (K) clockwise to its stop position. (See Fig.8 a, b)
- Fit the Burner Pan(F) onto the Stem(H), and ensure is sealed properly.(Fig 5)

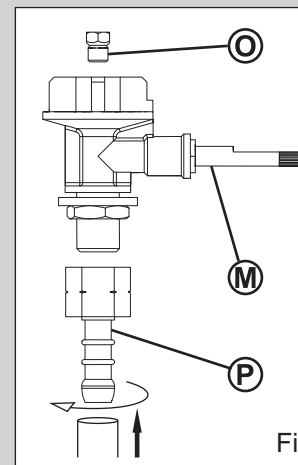

Fig. 4

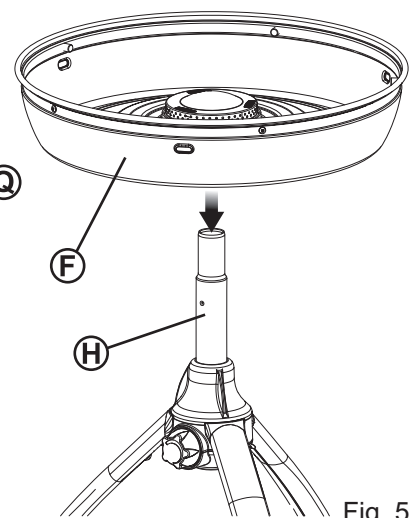
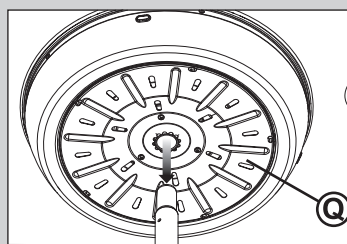

Fig. 5

## 6. Fitting and Changing the Gas Container

- Before fitting the regulator to a gas container, ensure that the seal on the regulator is in position and in good condition. This should be done with every connection.
- Ensure that the gas container is fitted or changed in a well-ventilated location, preferably outdoors, away from any source of ignition such as naked flames or electric fires and away from other people.
- Making sure that the gas container is kept upright, screw the regulator onto the container until it is fully engaged. Hand-tighten only.
- If there is a leak on your appliance (smell of gas), take it outside immediately into a well-ventilated flame-free location where the leak may be detected and stopped. If you wish to check for leaks on your appliance, do it outside using soapy water only, which is applied to the joints. The formation of bubbles will indicate the gas leak.
- Check that all the connections are securely fitted and re-check with soapy water. If you cannot rectify the gas leak, **do not use the appliance**. Contact your local CADAC stockist for assistance.
- When changing a gas container, firstly close the container valve (if fitted) and then turn the Control Knob (K) clockwise to its stop position. Ensuring that the flame is extinguished, unscrew the regulator. Refit a full container following the same precautions as described above.



## 7. Using the Appliance

**Caution: As accessible parts become very hot, the use of oven gloves is advisable. Keep young children away from the appliance.**

- Assemble the tri pod as described in Section 5
- Place the Burner Base Plate (Q) and the Fat pan (F) on the stem and tri pod assembly.
- Light the appliance as described in Section 8.
- Select your cooking method/cooking surface and place this in the Fat Pan.
- To prepare the non stick Reversible Grill Plate / BBQ Grid for use, place the Grill Plate / BBQ Grid inside the burner pan so that it rests securely on the locators inside the burner pan.
- The Paella Pan locates on top of the pot stand
- The Reversible grill must at all times be used with the Flame Tamer (E). Failure to do this will result in damage to the non stick coating.
- The unit's burner will be affected by windy conditions – use the unit in an area shielded from wind during use.
- Adjust the heat as required by adjusting the gas flow on the control knob and start cooking.
- After completion of cooking close the valve and remove the cooking surface after it has cooled down.
- The fat pan can now be removed from the blue fat pan locator.
- After cooking and cleaning, pack the unit away for re-use.

## 8. Lighting the Appliance

### Precautions to observe before lighting.

- After prolonged storage, inspect the Base plate (Q) air holes for insects such as spiders, which could affect gas flow. If there is any evidence of insects / nests, the Base Plate must be removed and any foreign material cleaned out. After checking, re-fit all components into the prescribed position.
- Use this appliance only on a firm level surface.

### General

- The Control valve is closed by rotating clockwise up to its stop position and opened by anti-clockwise rotation.
- Adjust the flame intensity to the desired level by turning the Control knob (k) clockwise to decrease the flame and anti-clockwise to increase it (See Fig.8a & b).
- When cooking food with a high fat content, flaring may occur if the selected heat setting is too high. Should this happen, turn the heat down until the flaring ceases.

- Do not move the appliance when in use, apart from being an unsafe practice to move the appliance whilst lit it may cause flaring.
- After use, first close the valve on the gas container (where applicable). When the flame has extinguished, close the valve (M) on the appliance by turning the Control Knob (L) fully clockwise.

### Lighting up using a match or BBQ lighter

(See Fig. 8b)

- To light the appliance, light a match or barbecue lighter. Open up the Control valve slightly (K) as described under 'General' and light the appliance Burner (G). When starting cold, the appliance may be lit from the top (See Fig.8b) prior to fitting the desired cooking surface onto the Burner Pan (F).

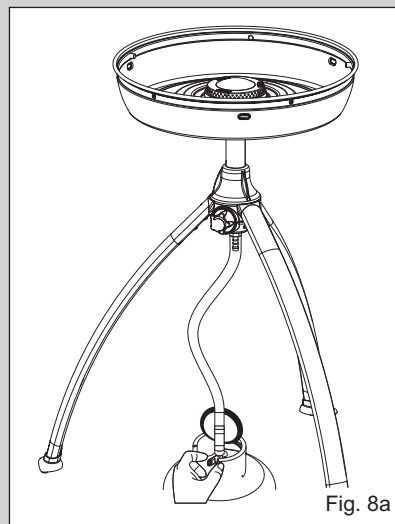

Fig. 8a

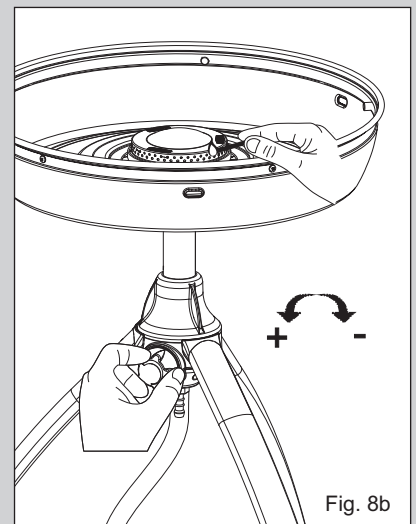

Fig. 8b

## 9. General Maintenance

- This appliance does not require scheduled maintenance.

### Replacing a Blocked Jet:

- Your GrilloGas is fitted with a specific size jet (O) to regulate the correct amount of gas.
- Should the hole in the Jet (O) become blocked, this may result in a small flame or no flame at all. Do not attempt to clean the Jet (O) with a pin or other such device as this may damage the orifice, which could make the appliance unsafe.
- To replace the Jet (O):. Unscrew the 3 screws on the bottom housing cover and remove cover.
- Remove Valve base plate assembly by unscrewing the six self-tapping screws fixing it to the Tripod housing (J) and subsequently remove the Valve (M) from the Housing simply by sliding it out.
- The Jet (O) will now be accessible at the top of the Valve (M).
- Unscrew the Jet (O) from the Valve (M) using a suitable spanner.
- Do not use pliers on the jet as this may damage the jet, making it unusable or impossible to remove. Screw the new jet into the valve. Do not over-tighten as this may damage the jet.
- Re-fit the valve and baseplate in the reverse order of assembly. When re-fitting the valve, ensure that the valve spindle aligns with slot in the Tripod housing.
- Reconnect the gas supply as described in the Assembly Instructions

### Replacing the Hose:

- The fitting of a hose is described in Section 6 - Assembly of the Appliance.

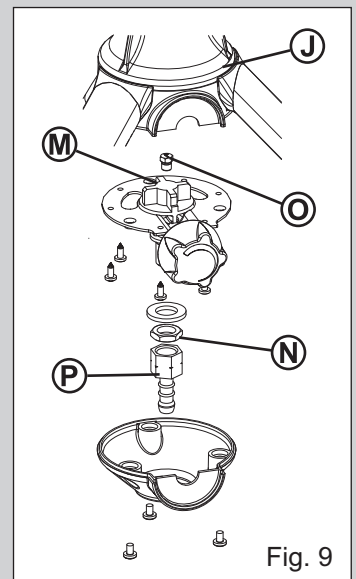

Fig. 9

## 10. Cleaning

- The grill plate is coated with a tough durable non-stick coating that has been used with great success on some of the best cookware in the world. Nevertheless, taking care of it can help you to enjoy extra years of healthy, easy, non-stick cooking.
- Use only low or medium heat settings to help retain the valuable nutrients in the food and maintain the non-stick surface.
- Whilst the non-stick coating is very durable, it can easily be damaged by the use of metal cooking utensils. It is therefore recommended that only plastic or wooden utensils be used when cooking.
- Do not overheat the grill plate and always add a little cooking oil to the surface before use.
- **Always allow the grill plate to cool before immersing it in water.**
- The use of abrasive detergents is not recommended, as this will permanently damage the non-stick surface.
- After cleaning recondition the surface with a light wipe of oil.
- Remove the fat from the moat of the Fat Pan.
- **Note:** For stubborn stains, oven cleaner may be used.

## 11. Storing and Carrying

- Always allow the unit to cool down before packing any part into its bag.
- Always store your CADAC Braai in the supplied bags, in a dry environment, preferably off the ground. This is especially important for the Burner pan stored in the Main bag so as to prevent the ingress of dirt or insects that may affect the gas flow.
- Should the appliance operate abnormally after storage and all checks referred to in Sections 4 & 7 have not isolated any problem, the Venturi may be blocked. A blocked Venturi would be indicated by a weaker yellowish flame or no flame at all in extreme cases. Under these circumstances it will be necessary to remove the Burner (G) as described under Section 10 - General Maintenance, and to check and thoroughly clean out any foreign matter which may have gathered in the Venturi.

## 12. Returning the Appliance for Repair or Service

- Do not modify the appliance, as this could be dangerous.
- If you cannot rectify a fault by following these instructions, contact your local CADAC distributor for details on how to return the product for attention.
- Your CADAC GrilloGas is guaranteed by CADAC for a period of 2 years against factory fault.

## 13. Spare parts and Accessories

- Always use genuine CADAC spares as they have been designed to give optimum performance.

SPARES	
Jet No. 81 (I3B/P(30) & I3+(28-30/37))	740-SP014
Jet No. 74 (I3B/P(37))	740-SP029
Jet No. 69 (I3B/P(50))	740-SP015
Pot/Paella Stand	740-SP002
Burner Assembly	740-SP005
Pot Stand Sleeve	740-SP006
Rubber Locator	740-SP007
Fat Pan	740-SP008
Aluminium Reversible Grill Plate	740-SP003
Flame Tamer	740-SP004
Burner Base Assembly	740-SP009
1/4" BSP LH tailpiece and Nut	8154-6

ACCESSORIES	
Paella Pan 36	8600-100
Reversible Grill Plate & Flame Tamer	8600-210
BBQ Grid	8600-200
Pizza Stone	98368
Dome	8600-220
Dual Power Pak	346-10
Vertical EN417 Regulator Assembly	349