

Installation Instructions

Kit NGX SERIES 2nd Bill Acceptor Kit #26679701

These instructions outline the procedures to install the 2nd bill acceptor into your NGX and NGX MINI jukeboxes.

Tools Required

11/32 Nut Driver.

¼ Nut Driver.

Phillips Screwdriver.

Bill Acceptor.

Parts Included with this Kit:

<u>Item #</u>	<u>Part Number</u>	<u>Description</u>	<u>Quantity</u>
1	34100002	Dual BA Circuit Board Assy.	1
2	34022350	Dual Bill Acceptor Harness	2
3	40990201	Panel Graphics 2BA,CC, CA	1
4	87843000	#8-32 Hex Nuts (Not Shown)	2
		These Instructions	

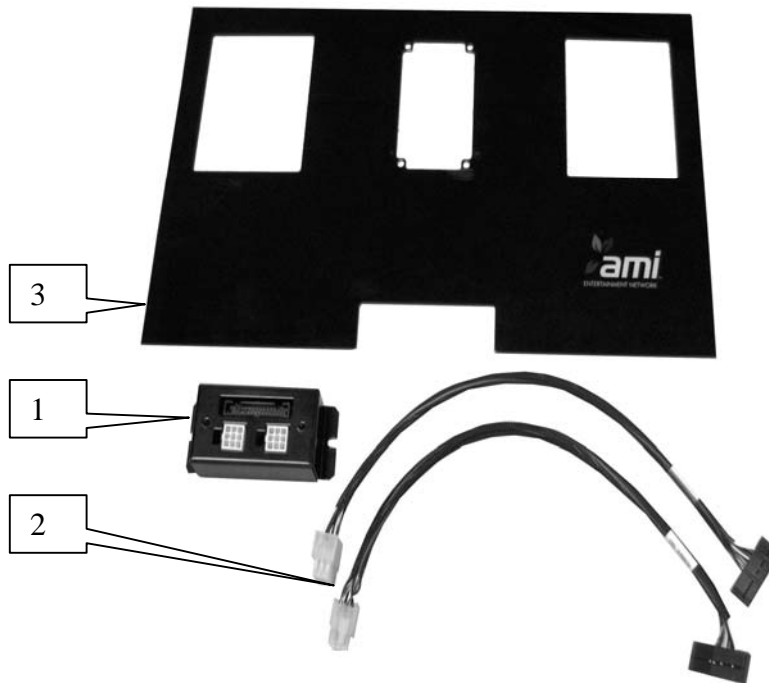

Figure 1

NGX Installation see next page.

NGX Mini Installation see page 3.

NGX INSTALLATION PROCEDEURE

Installing a 2nd bill acceptor into an NGX currency module requires partial disassembly of the currency module door, relocating the coin mech to the center of the door, and replacing the front graphic panel. Follow the step by step instructions to install this kit.

1. Power off and unplug the NGX jukebox. Open the currency module and allow the door to be held open by the fall stop cable.
2. Disconnect the wiring to the coin mech and bill acceptor. Store the wires out of the way inside the currency module cabinet.
3. Remove the four screws holding the coin mech to the door. Remove the coin mech.
4. Remove the four nuts holding the bill acceptor to the door. Remove the bill acceptor.
5. Remove the four nuts holding the blackout plate in the center of the door and remove the blackout plate. Retain the four nuts.
6. Remove the four nuts holding the coin mech bracket and remove the coin mech bracket. Retain both the nuts and the bracket.
7. Remove the three nuts holding the top cap bracket. Retain the nuts and the top cap bracket.
8. Loosen the two nuts holding each of the two end cap brackets.
9. Close and lock the currency module door. Carefully pull up on the Graphic Panel to slide it out of the bottom retainer and remove it from the door. Leave the plastic spacer and lighting panel in place.
10. Install the new Graphic Panel (Item #3). Be sure to line up the graphic panel and plastic spacer evenly in the two bill acceptor openings on each side of the panel.
11. Open the currency module door and reinstall the top cap bracket. Tighten the nuts holding the two end cap brackets.
12. Using four nuts retained from step 5, install the coin mech bracket in the center position on the back of the door. Reinstall the coin mech.
13. Install the Dual Bill Acceptor Circuit Board Assembly (Item #1) using two 8x32 keps nuts from the kit (Item #4).
14. Plug the 18 pin plug from the main currency module harness into the dual bill acceptor interface and reconnect the two wires to the coin mech.

15. Plug the 9-pin connectors of the two Dual Bill Acceptor Harnesses (Item #2) from the kit into the Dual Bill Acceptor Circuit Board Assembly.

16. Before installing your bill acceptors set the switch's for your NGX jukebox as follows. The MEI AE-2681 switch's 1,2,3 must be **ON** the rest are **OFF**. The Coinco Vantage switch's 1,2 must be **ON** and the rest are **OFF**.

17. . Install the two bill acceptors using the four nuts from step 4 and four nuts from step 5. Plug one bill acceptor harness into each bill acceptor.

18. Power up the jukebox and verify operation of the coin mech and both bill acceptors using the Credit Test screen in the Service Mode.

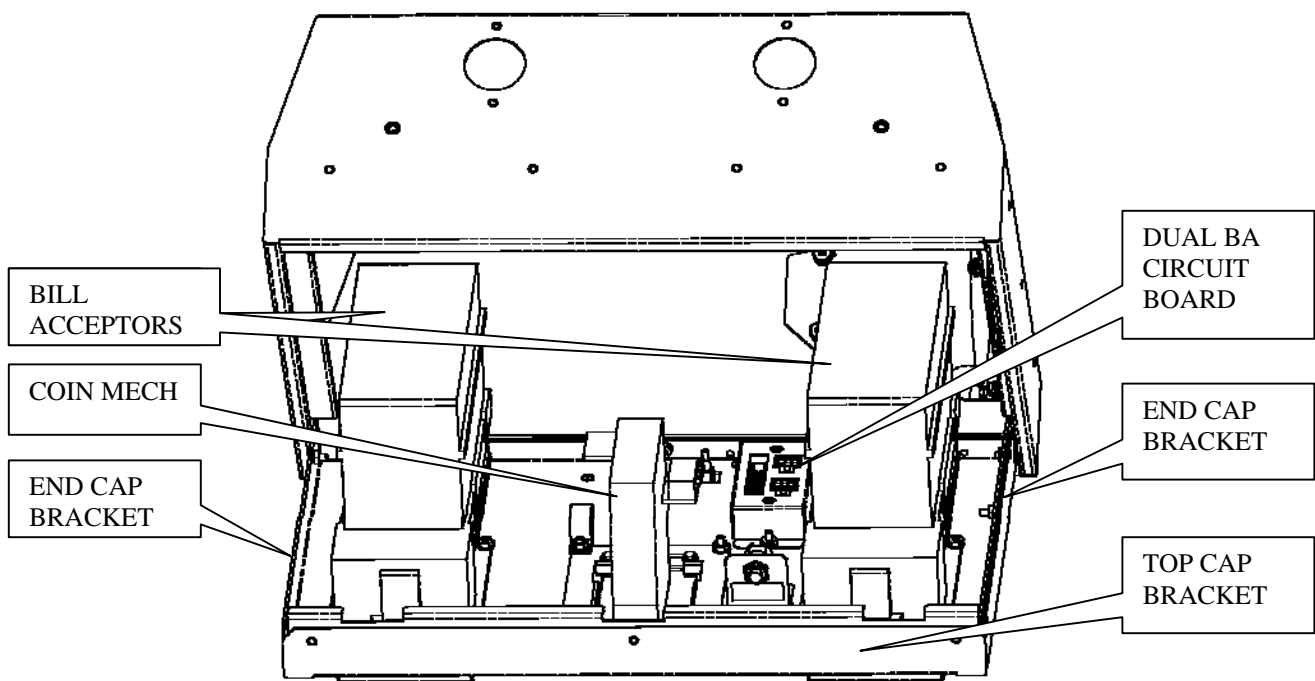

Figure 2

NGX MINI INSTALLATION PROCEDURE

Installing a 2nd bill acceptor into an NGX MINI requires removing the currency panel from the jukebox door, moving the coin mech to the center of the door, and replacing the front graphic panel. Follow the step by step instructions to install this kit.

1. Power off and unplug the NGX jukebox. Open the jukebox door.
2. Disconnect the front door harness from the currency panel and remove from the cable clamps. Store the harness in the monitor cable clamps above the currency panel.

3. Remove the coin box and remove the two nuts that secure the coin box retainer, set aside for later installation.
4. Remove the six nuts and three cable clamps securing the currency panel to the jukebox door. Remove the currency panel to a flat work surface.
5. Remove the four screws holding the coin mech to the door. Remove the coin mech.
6. Remove the four nuts holding the blockout plate in the center of the door and remove the blockout plate. Retain the four nuts.
7. Remove the four nuts holding the coin mech bracket and remove the coin mech bracket. Retain the nuts and the bracket.
8. Remove the four nuts holding the bill acceptor to the currency panel. Remove the bill acceptor. Retain the nuts and the bill acceptor.
9. Remove the two metric screws retaining the credit card reader. Remove the credit card reader.
10. Remove the eight screws along the perimeter of the currency panel. Separate the two metal panels and carefully lift the light panel and plastic spacer, remove the graphics panel underneath.
11. Install the new Graphic Panel (Item #3). Be sure to line up the graphic panel and plastic spacer evenly in the two bill acceptor openings on each side of the panel.
12. Reinstall the outer currency panel and eight screws.
13. Using four nuts retained from step 7, install the coin mech bracket in the center position on the back of the door. Reinstall the coin mech and credit card reader.
14. Install the Dual Bill Acceptor Circuit Board Assembly (Item #1) using two 8x32 keps nuts from the kit (Item #4).
15. Before installing your bill acceptors set the switch's for your NGX MINI jukebox as follows. The MEI AE-2681 switch's 1,2,3 must be **ON** the rest are **OFF**. The Coinco Vantage switch's 1,2 must be **ON** and the rest are **OFF**.
16. Plug one bill acceptor harness into each bill acceptor. Install the two bill acceptors using the four nuts from step 8.
17. Reinstall the currency panel into the jukebox and secure with 6 nuts and three cable clamps removed in step # 4. Install the coin box retainer under the coin mech and secure with two nuts

18. Reinstall the front door harness into the original cable clamps on the currency panel.
19. Reconnect the credit card reader cable. Connect the two coin mech wires to the “C” common and “NO” normally open of the coin mech.
20. Plug the 18 pin plug from the front door harness into the dual bill acceptor interface
Plug the 9-pin connectors of the two Dual Bill Acceptor Harnesses (Item #2) from the kit into the Dual Bill Acceptor Circuit Board Assembly.
21. Install the coin box into the holder. Power up the jukebox and verify operation of the coin mech and both bill acceptors using the Credit Test screen in the Service Mode.

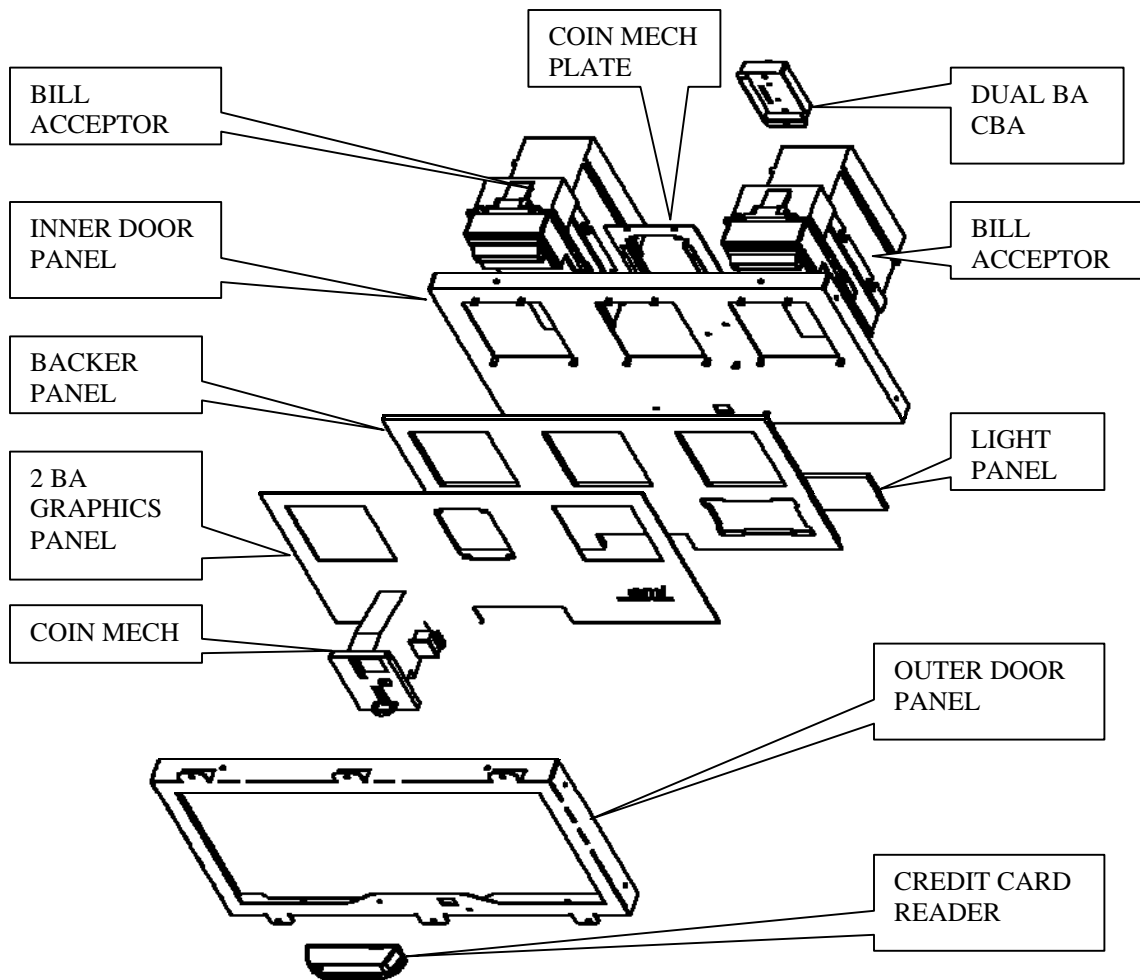

Figure 3



ENTERTAINMENT NETWORK