



BATTERY TIEDOWN KIT (BAT-001) INSTRUCTIONS

GENERAL DESCRIPTION

The Battery Tiedown Kit is designed to secure an aftermarket battery to the stock Suzuki Samurai battery tray. This kit comes complete with a battery tiedown bracket and all hardware necessary to mount it to the stock Samurai battery tray. The Battery Tiedown Kit will secure a battery up to 7-1/16" in width.

To install the Battery Tiedown Kit, start by assembling the Angled Tab to the stock battery tray using the metric button head screw. With the battery in place, assemble both hooks, Tiedown Bracket, Washers and Wing Nuts. Hooks are designed to accommodate a variety of battery heights so they can be cut shorter to fit for cosmetic appearance.

SPIDERTRAX INC ~ Phone: (800) 286-0898 ~ **Web:** www.spidertrax.com

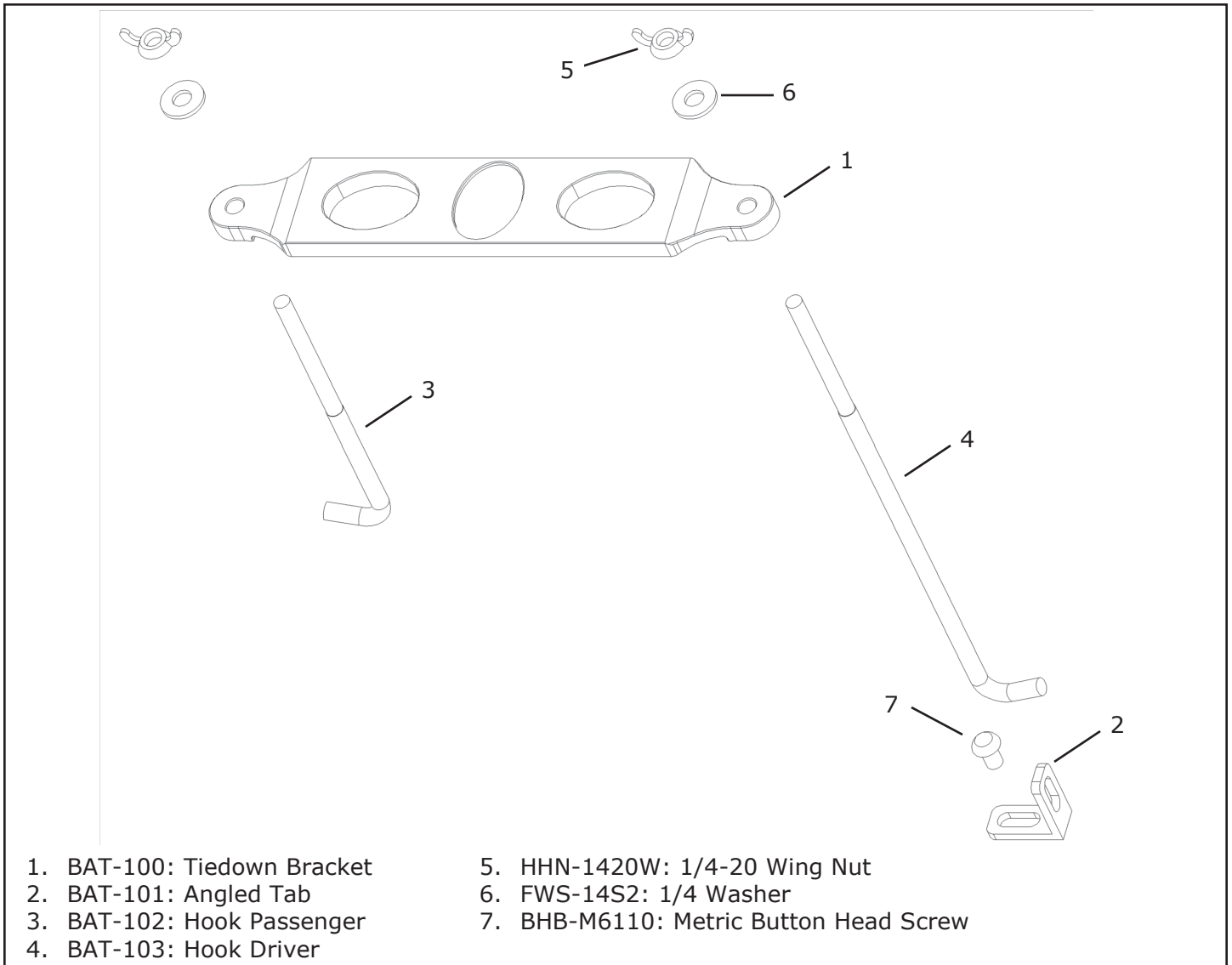

Fig. 1