



POLYMOUNT KIT (PLM-001) INSTRUCTIONS

GENERAL DESCRIPTION

The Polymount Kit is designed to provide a secure mounting system for the Suzuki Samurai transfer case. This kit comes complete with a set of polyurethane mounting bushings with matching bolts, nuts, and washers.

To install the Polymount Kit, replace the OEM rubber transfer case mounts with the polyurethane mounts as shown in the figure below. When tightening the bolt, the space between the frame member and the transfer case mount should be 1 1/16".

SPIDERTRAX INC ~ Phone: (800) 286-0898 ~ **Web:** www.spidertrax.com

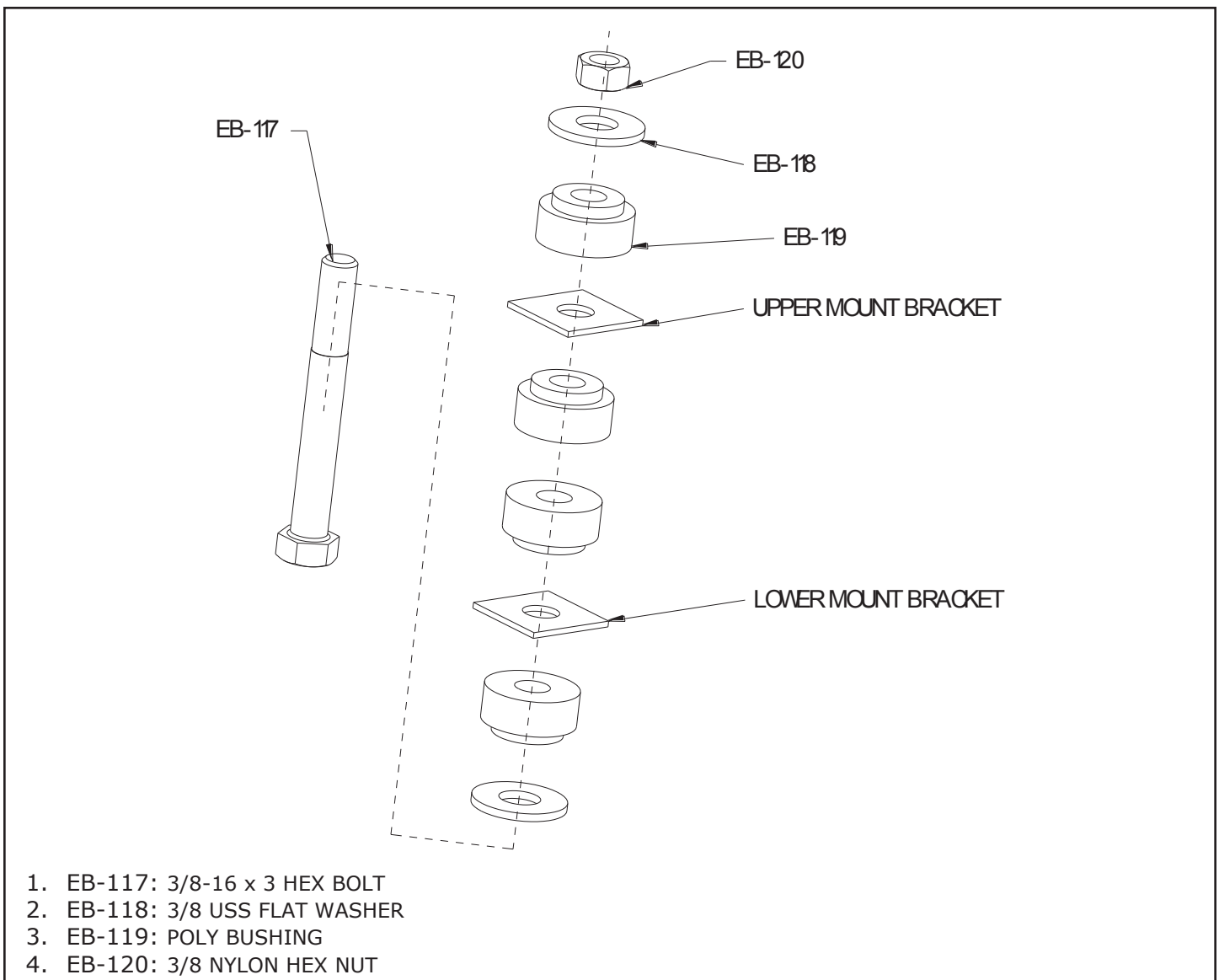

Fig. 1