

Outdoor Fire Pit Assembly Instructions

Congratulations on your purchase of a Harley-Davidson® Outdoor Portable Fire Pit.

The utmost care has gone into the design and manufacturing of this product.

Please read these instructions carefully.

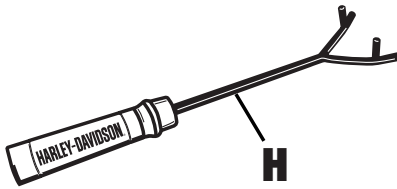
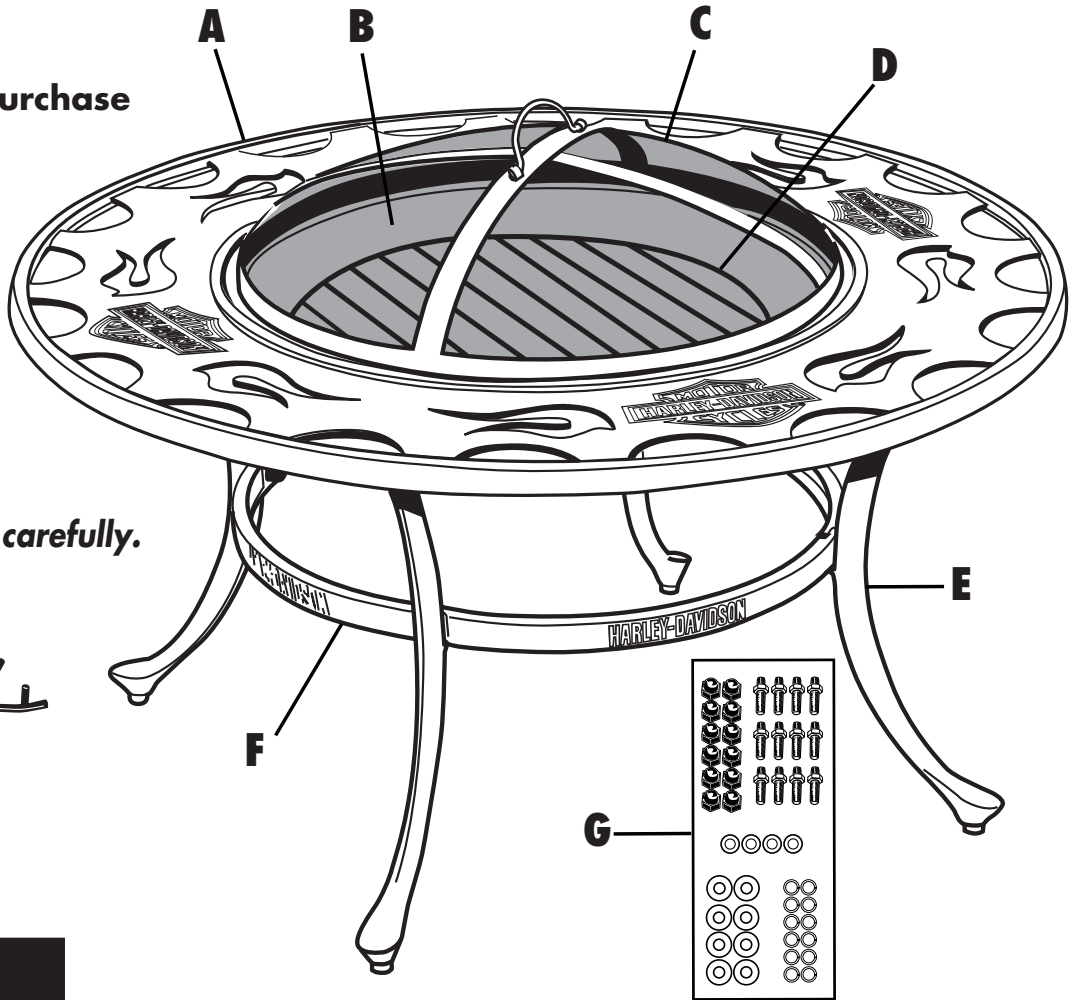

Parts List

| Part | Qty. | Description |
|----------|----------|---------------------|
| A | 1 | Aluminum Cast Table |
| B | 1 | Iron Bowl |
| C | 1 | Mesh Screen Lid |
| D | 1 | Bottom Grate |
| E | 4 | Legs |
| F | 4 | Support Rims |
| G | 1 | Hardware Kit |
| H | 1 | Poker Tool |

Important Safety Tips

When using a fire pit, always use common sense, follow the manufacturer's directions, and find out what the town requirements are. The following can serve as a guide:

- DO NOT use fire pit in the house, too close to the house, on the grass, or near any type of combustibles that could catch fire.
- DO NOT stack the wood too high, this will keep the wood from falling out.
- DO NOT use lighter fluid or gasoline. Use fire starters.
- Keep the fire pit adequately away from outdoor furniture.
- Never leave the fire pit unattended while the fire is still burning.
- In case of an emergency, always have a fire extinguisher on hand.

Tools Required:

Screwdriver & Adjustable Wrench

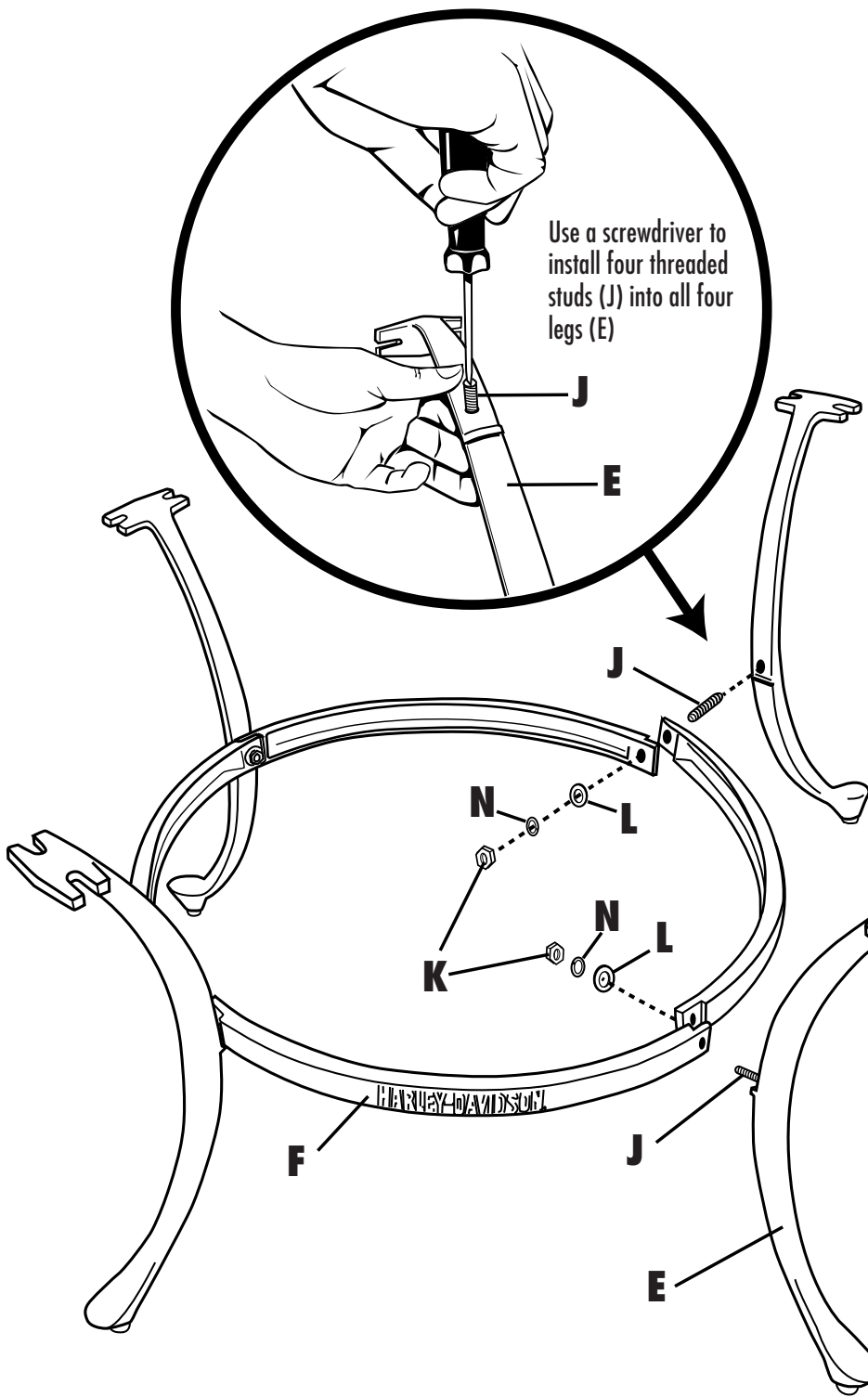

| Hardware Kit | | |
|--------------|------|----------------|
| Part | Qty. | Description |
| I | 12 | Plastic Caps |
| J | 12 | Threaded Studs |
| K | 12 | Nuts |
| L | 4 | Small Washers |
| M | 8 | Large Washers |
| N | 12 | Lock Washers |

Hardware Kit (G)

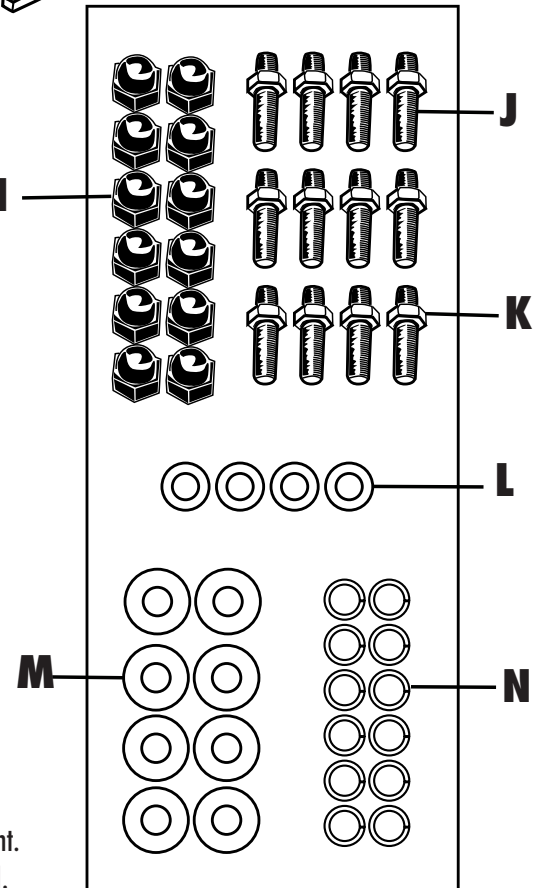

STEP 1: Use four threaded studs (J), from the hardware kit (G). Remove the nuts (K) and set aside. Use a screwdriver to install the threaded studs (J) into the four legs (E).

STEP 2: Locate the four support rims (F), make sure that custom emboss Harley-Davidson® logo is upright on all four sides when installing to the legs (E) as shown in diagram above.

STEP 3: Secure the support rims (F) to legs (E) with the small washers (L), lock washers (N) and reinstall nuts (K) as shown in diagram above.

STEP 4: Make sure all legs (I) and support rims are straight and custom emboss logos are upright. Then use an adjustable wrench to tighten all hardware and all parts in place, DO NOT OVER TIGHTEN.

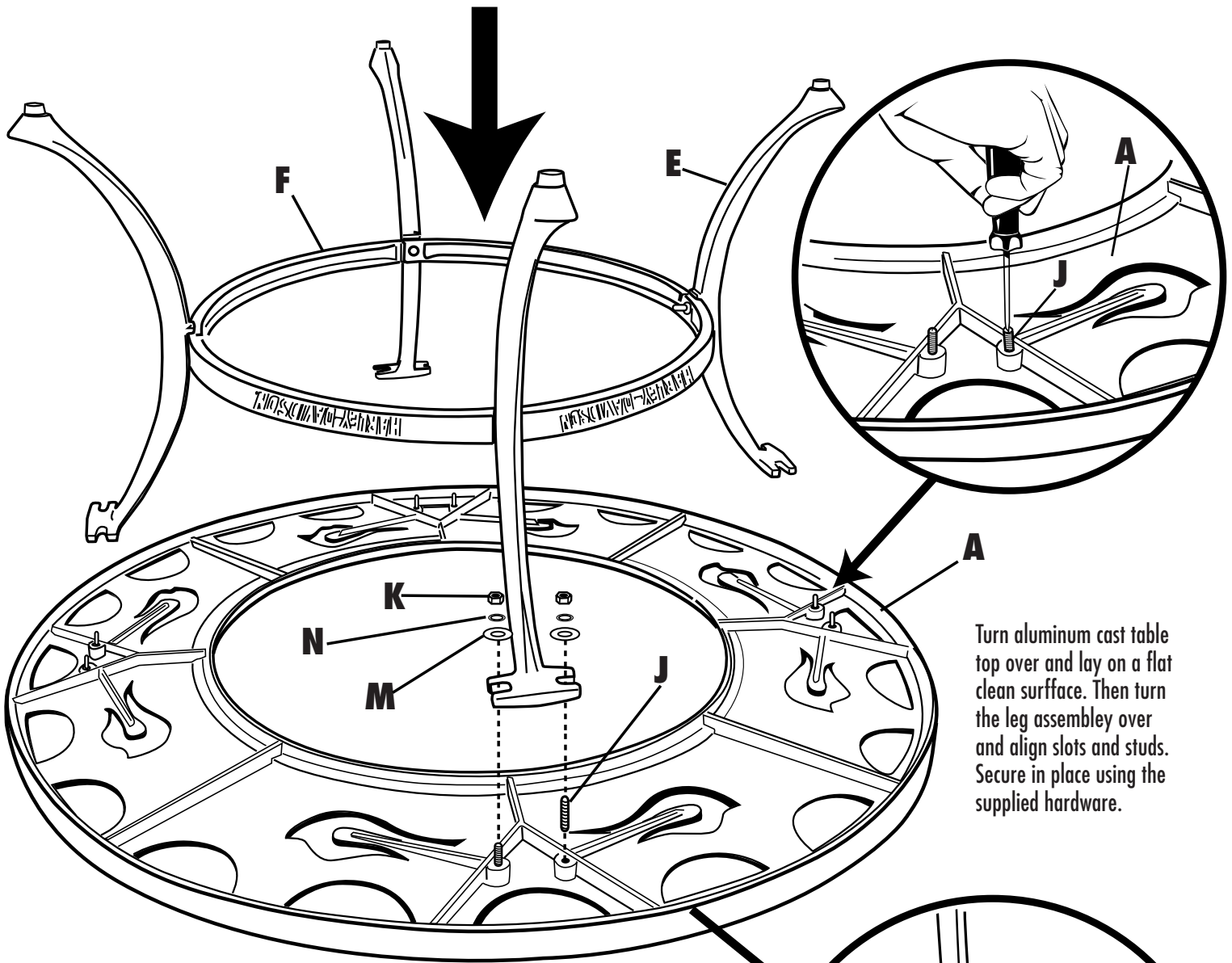

Turn aluminum cast table (A) over and lay on a flat clean surface. Then turn the leg assembly over and align slots and studs. Secure in place using the supplied hardware.

STEP 5: Turn aluminum cast table (A) over and lay flat on a soft clean surface.

STEP 6: Use a screwdriver to install eight threaded studs (J) into the eight threaded holes around the table (A) as shown in the diagram above.

STEP 7: Turn the leg assembly over and lower onto the table (A). Align the studs through the slots of the legs (E). You might have to flex the legs to fit in place as shown in the diagram above.

STEP 8: Attach the supplied hardware from the hardware kit (G) and secure the leg assembly in place using the large washers (M), lock washers (N) and nuts (K) as shown in the diagram above. **DO NOT OVER TIGHTEN.**

STEP 9: When assembled, turn fire pit upright to ensure all legs (E) are straight and the table surface is level then fully tighten all nuts (K).

STEP 10: Attach all twelve plastic caps (I) onto all exposed nuts (K) and threaded studs (J).

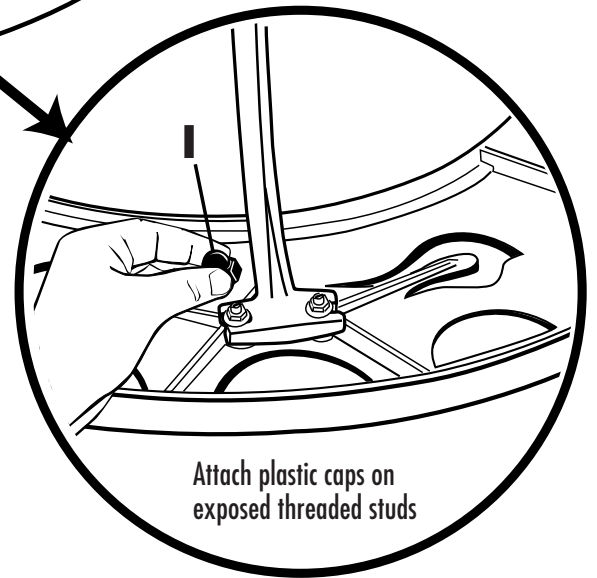

Attach plastic caps on exposed threaded studs

STEP 11: Turn aluminum cast fire pit frame to upright position, place the iron bowl (B) into hole, then place grate (D) down into bowl.

STEP 12: Attach the mesh screen lid (C). **NOTE:** Never attempt to remove mesh screen lid by hand when fire pit is hot, use the poker tool (H) to remove the mesh screen lid (C).

STEP 13: Relax and enjoy the warmth around a comfortable fire.

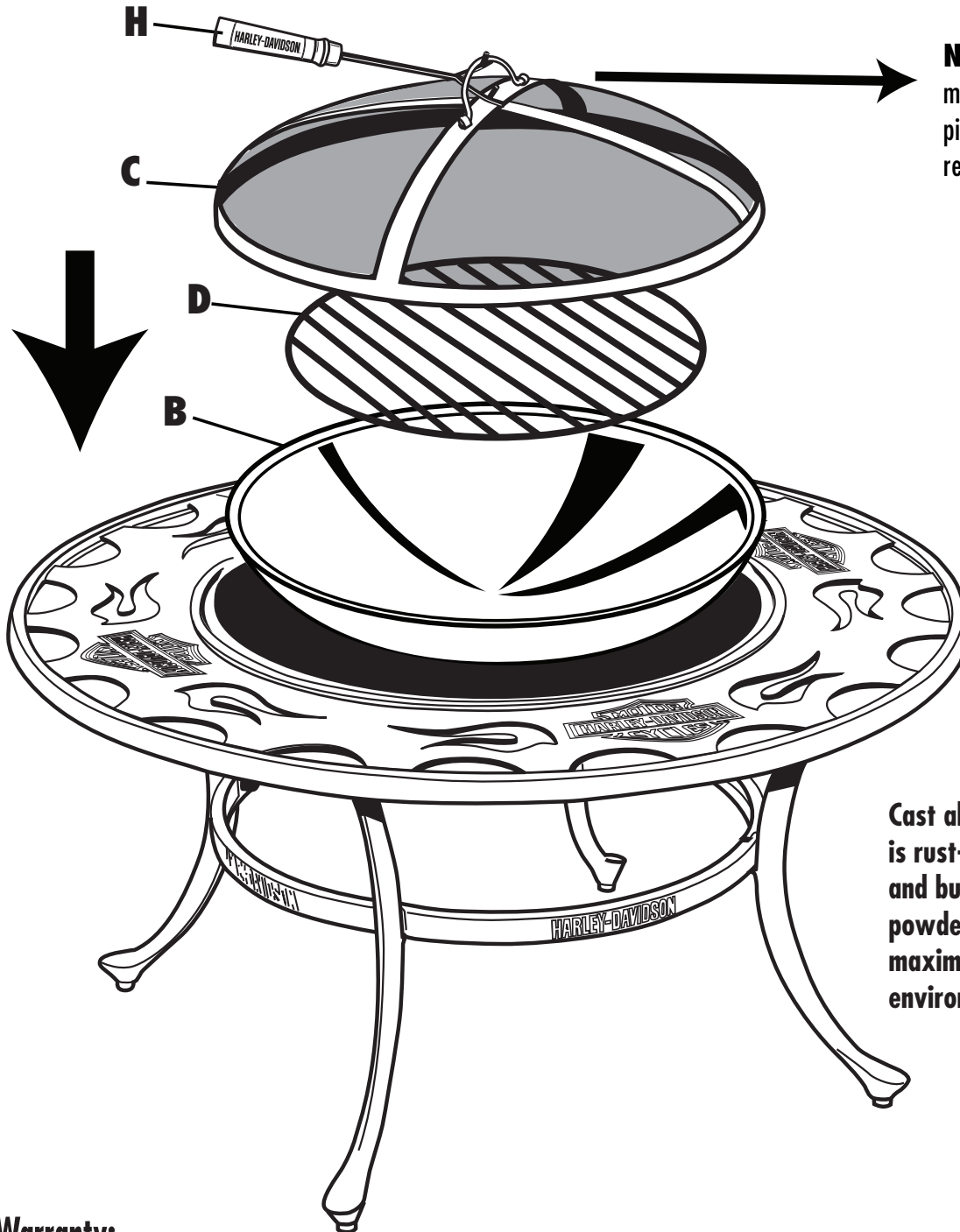

NOTE: Never attempt to remove mesh screen lid by hand when fire pit is hot, use the poker tool (H) to remove the mesh screen lid (C).

Cast aluminum outdoor furniture is rust-free, relatively lightweight, and built to last. Each piece is powder coated, which provides maximum protection against environmental threats.

Warranty:

Free replacement of any part that fails within one year from day of manufacture, excluding shipping costs. Void if damaged by misuse, accidents, alterations, failure to follow instructions, fire, flood, and acts of God.

If you have any questions or comments, please contact us at:

BrandedProducts.com