



DRIVESHAFT SPACER KIT INSTRUCTIONS

GENERAL DESCRIPTION

The Driveshaft Spacer Kit (DSP-001 thru DSP-006) is designed to add length to your driveshaft so the stock Samurai driveshafts can still be used with vehicle lifts. This kit comes complete with an anodized aluminum spacer and matching bolts, nuts, and lock washers. The Driveshaft Spacer Kit is a bolt on product and installs in the same fashion as installing a driveshaft. Driveshaft Spacer Kits are available in 3/4", 1", and 1-1/4" sizes.

To install the Driveshaft Spacer Kit, follow these steps:

- 1) Remove driveshaft from either t-case or carrier as per Suzuki service manual procedures.
- 2) Reassemble driveshaft so spacer is sandwiched between driveshaft and driveshaft flange. Raised lip portion on spacer should fit into driveshaft flange. Use hardware included with this kit to assemble driveshaft and tighten hardware to 17.0-21.5 lb-ft [23-30 N*m]. With spacer installed, there should be approximately 3/4" of spline not engaged with driveshaft slip yoke.

SPIDERTRAX INC ~ Phone: (800) 286-0898 ~ Web: www.spidertrax.com

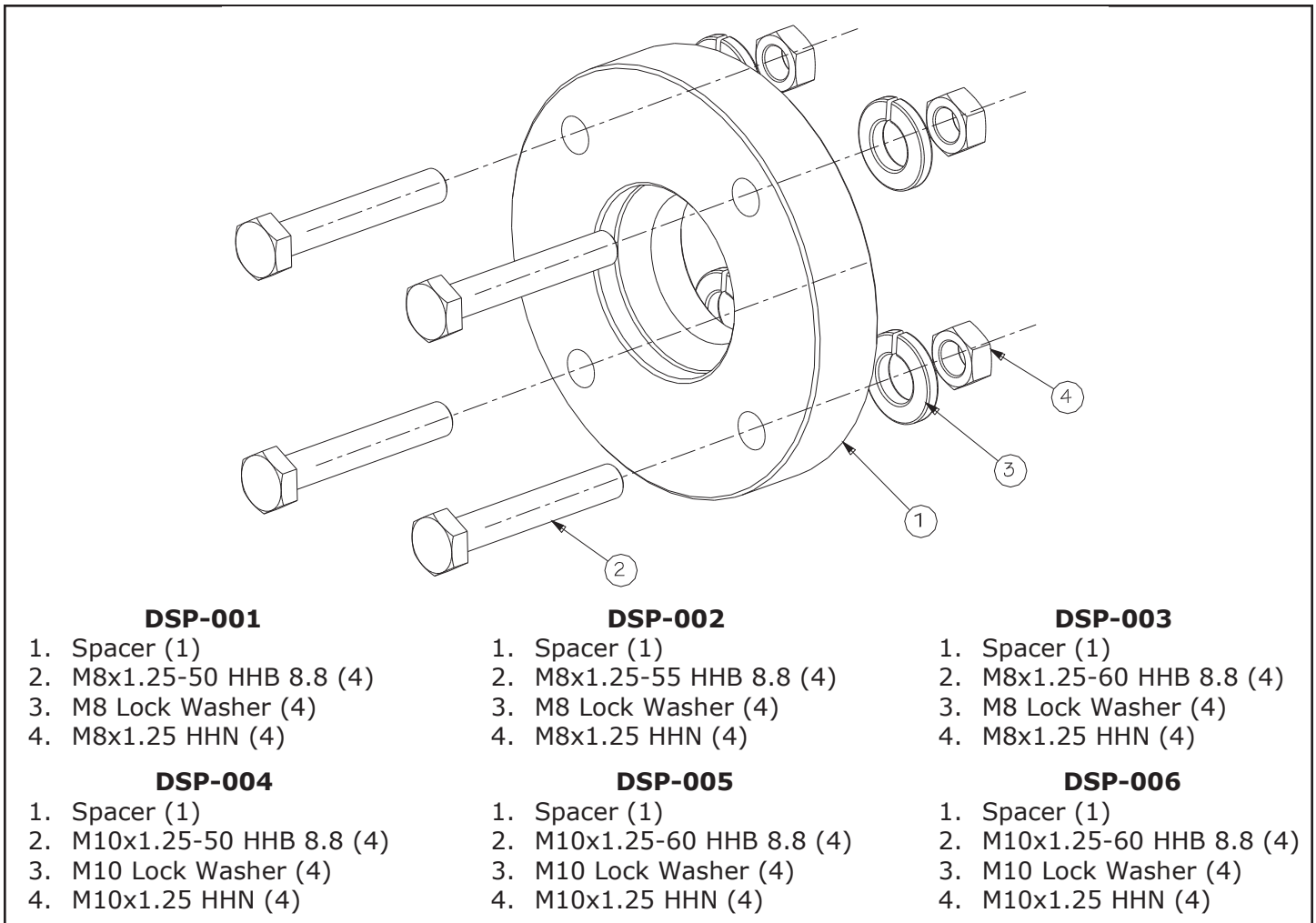

Fig. 1